

Grohe Uniset Element for WC with EPS housing and support feet

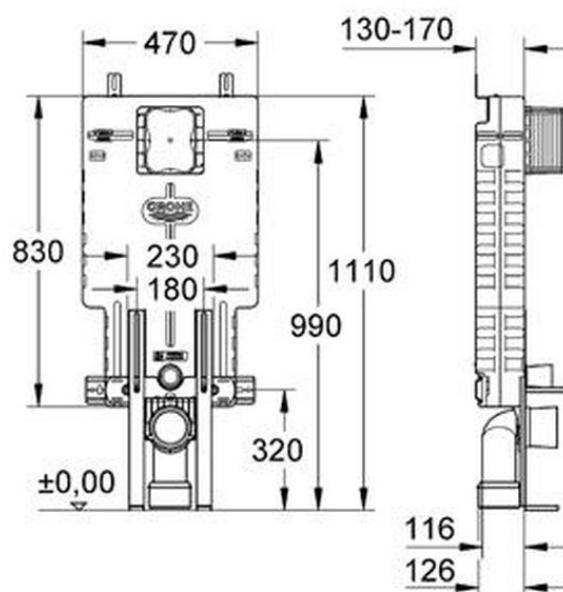

Range:	Uniset
Description:	with flushing cistern GD 2, 6 - 9 l sound-insulating EPS module for masonry-in 830 x 470 x 130 mm rail adaptors for modular fixing wall rail with fixing accessories for single installation 2 WC fixing bolts distance of fixing bolts 180/230 mm fixing device for ceramic outlet bend Ø 90 mm depth adjustable reducer Ø 90/110 mm inlet and outlet connecting set flushing cistern GD 2, 6 - 9 l, containing following features: adjustment ex factory 6 l and 3 l pneumatic discharge valve offering 3 modes of operation: dual flush or start/stop or single flush water supply from left/right/back or top low noise (group I acc. to German Noise Specification) insulated against condensation 1/2" water supply connection including integrated angle valve and push fit flexible hose union no tools required for the installation of the inspection shaft including protection during construction phase preparation for shower toilets with additional accessory 40 899 000 (sold separately) for mounting of small flush plates please order revision shaft 40 911 000 (sold separately)
Product Code:	G-38642001
ERP Code:	G-38642001
Barcode:	4005176865404
Product Features:	10 Year Warranty
Dimensions:	(l) 1125mm x (w) 506mm x (h) 145mm
Package Weight:	8.8
CAD3D:	Download

Product Images



MOT



10 Year Warranty