

# Grohe Euroeco Infra-red electronic wall basin tap without mixing device

**Range:** Euroeco

**Description:** with infrared sensor for bi-directional communication for monitoring, configuration and servicing for cold or premixed water 6 V lithium battery, type CR-P2 battery lifetime: approx. 7 years (150 actuations a day) GROHE Long-Life finish GROHE Water-Saving mousseur 5.7 l/min metal body multistage battery status display 7 pre-set programs: auto flush thermal disinfection cleaning mode additional functions and precise settings by remote control 36 407 CE approved min. recommended pressure 1.0 bar



**Product Code:** G-36274000

**ERP Code:** G-36274000

**Barcode:** 4005176893223

**Product Features:** 2 Year Warranty

**Dimensions:** (l) 377mm x (w) 230mm x (h) 74mm

**Package Weight:** 1.51

**CAD3D:** [Download](#)

## Product Images

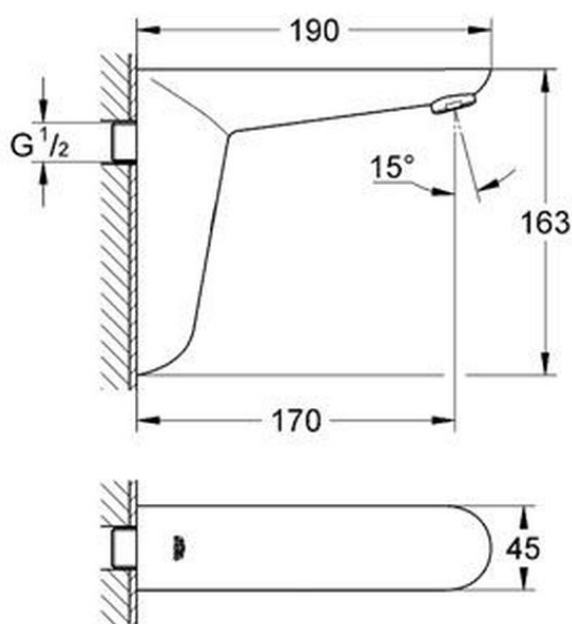

## Flow Chart

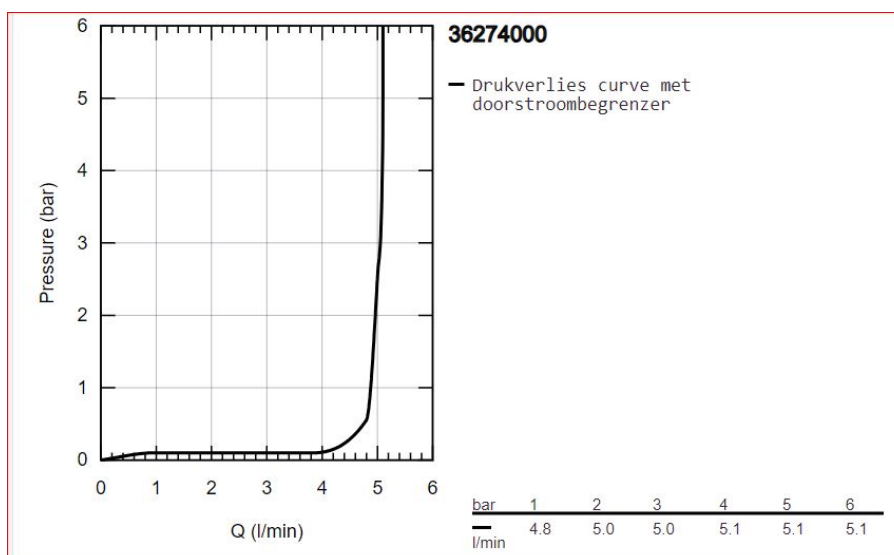

MOT



2 Year Warranty