

Grohe Eurosmart Single-lever sink mixer 1/2"



Range: Eurosmart

Description: low spout single hole installation GROHE Long-Life chrome finish GROHE SilkMove 35 mm ceramic cartridge flow straightener with integrated temperature limiter pull-out dual spray - switches back and forth between regular flow and spray diverter: laminar spray/SpeedClean shower jet automatic return to laminar spray adjustable flow rate limiter swivel cast spout swivel area 90deg GROHE Zero isolated inner water ways - lead and nickel free within the faucet flexible connection hoses 3/8 GROHE FastFixation Plus installation system protected against backflow

Product Code: G-30305001

ERP Code: G-30305001

Barcode: 4005176635465

Product Features: GROHE SilkMove, 20 Year Warranty, GROHE Long-Life finish

Dimensions: (l) 390mm x (w) 325mm x (h) 60mm

Package Weight: 2.35

CAD3D: [Download](#)

Product Images

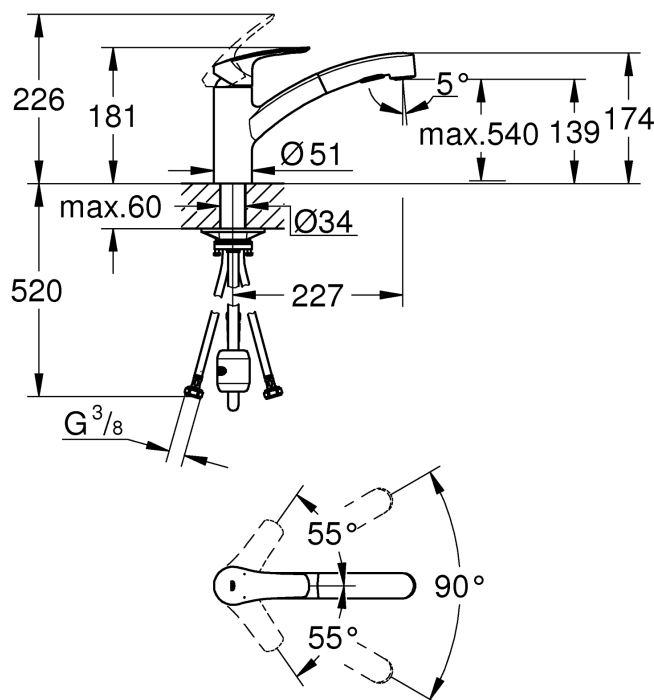

Flow Chart

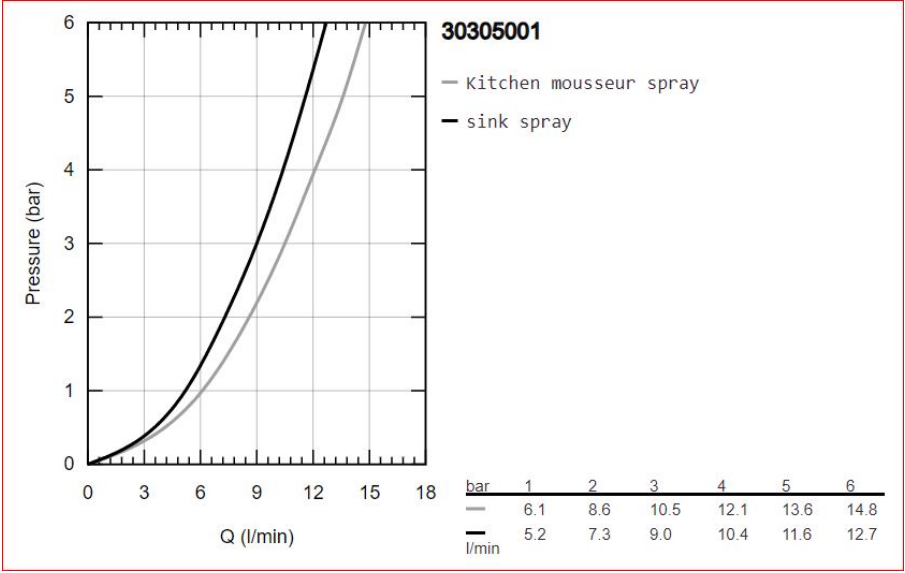

MOT



20 Year Warranty



GROHE SilkMove



GROHE Long-Life finish