

# Grohe Non Rapido Concealed stop-valve, 1/2

<b>Range:</b>	Non Rapido
<b>Description:</b>	pre-assembled headpart 1/2", short spindle, protection sleeve, threaded union 1/2", DR-brass
<b>Product Code:</b>	G-29800000
<b>ERP Code:</b>	G-29800000
<b>Barcode:</b>	4005176504839
<b>Product Features:</b>	5 Year Warranty
<b>Dimensions:</b>	(l) 136mm x (w) 82mm x (h) 54mm
<b>Package Weight:</b>	0.36
<b>CAD3D:</b>	<a href="#">Download</a>

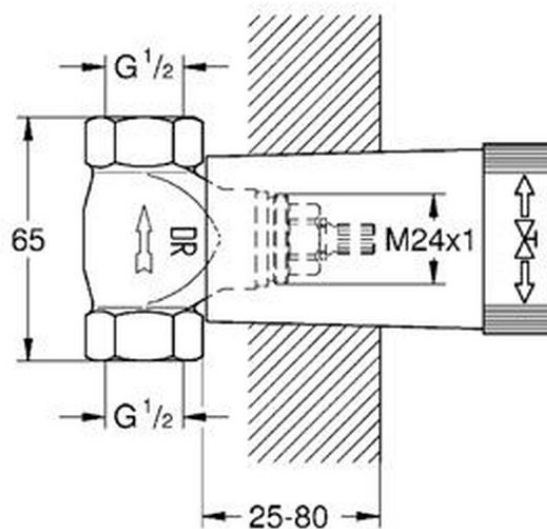

## Product Images



MOT



5 Year Warranty