

Grohe Eurosmart Single-lever basin mixer 1/2"M-Size

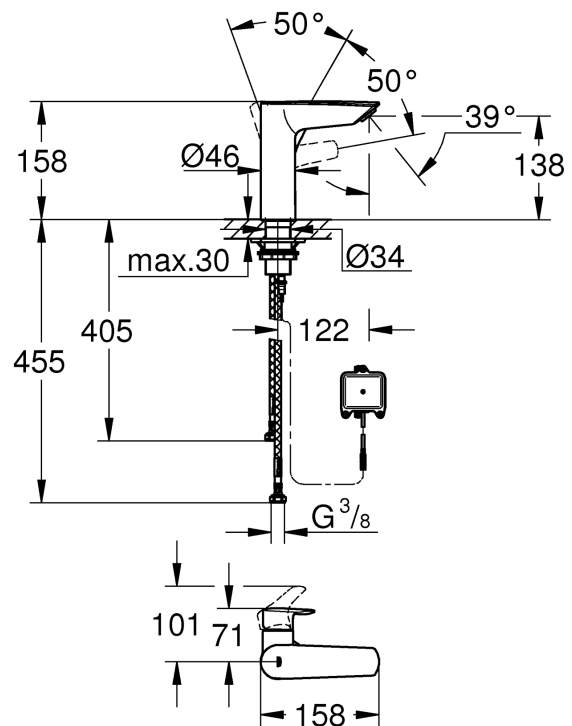

Range:	Eurosmart
Description:	single hole installation 2-in-1 hybrid with touchless or manual operation manual lever operation having priority metal lever GROHE SilkMove 28 mm ceramic cartridge with temperature limiter infra-red electronic with infrared sensor for bi-directional communication for monitoring, configuration and servicing 6 V lithium battery, type CR-P2 battery lifetime: approx. 7 years (150 actuations a day) non-return valve dirt strainer with integrated solenoid valve external battery multistage battery status display 7 pre-set programs: auto flush cleaning mode additional functions and precise settings by remote control 36 407 GROHE Long-Life chrome finish GROHE Water-Saving mousseur 5.7 l/min GROHE Zero isolated inner water ways - lead and nickel free within the faucet rapid installation system smooth body flexible connection hoses min. recommended pressure 1.0 bar CE approved professional edition
Product Code:	G-23975003
ERP Code:	G-23975003
Barcode:	4005176644153
Product Features:	GROHE SilkMove, 20 Year Warranty, GROHE Water Saving
Dimensions:	(l) 420mm x (w) 230mm x (h) 145mm
Package Weight:	2.46
CAD3D:	Download

Product Images



Flow Chart

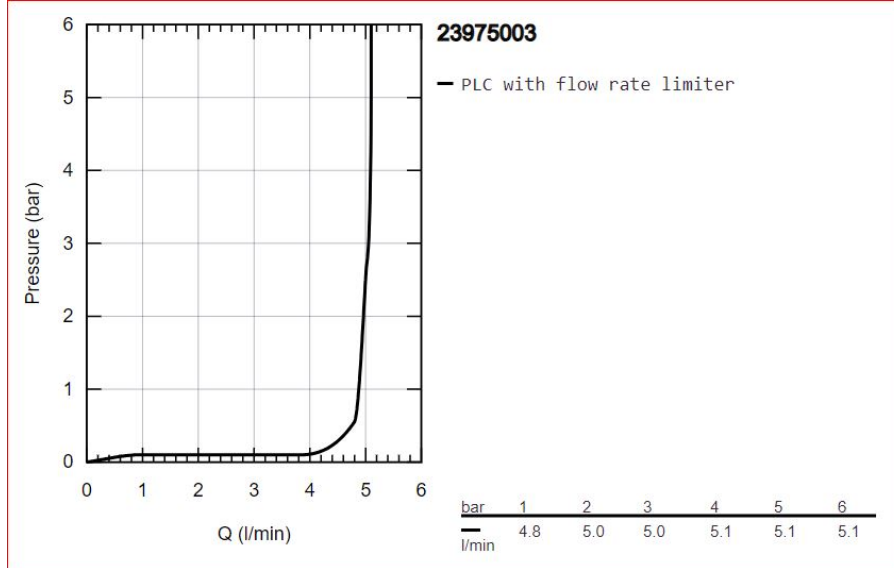

MOT



20 Year Warranty



GROHE SilkMove



GROHE Water Saving