

Grohe Eurosmart Cosmopolitan E Infra-Red Electronic Basin Mixer 1/2" + Mixing Device & Adj Temp Limiter

Range: Eurosmart Cosmopolitan E

Description: with infrared sensor for bi-directional communication , for monitoring, configuration and servicing, without power supply 36 338 000 (required), GROHE Water Saving - Less water, perfect flow, maximum flow rate (at 3 bar): 5 l/min, flexible connection hoses, non-return valve, dirt strainers, with integrated solenoid valve, rapid installation system, 7 pre-set programs, auto flush, thermal disinfection, cleaning mode, additional functions and precise settings , by remote control 36 407, CE approved, noise classification 1 in accordance , with DIN4109, type of protection faucet IP 59, replaces 36 325 001

**Product Code:** 36325002

ERP Code: 36325002

Barcode: 4005176318771

Product	2 Year Warranty, GROHE Water Saving
----------------	-------------------------------------

Features:

Dimensions: (l) 310mm x (w) 167mm x (h) 78mm

Package Weight: 1.53

CAD3D: [Download](#)

Product Images

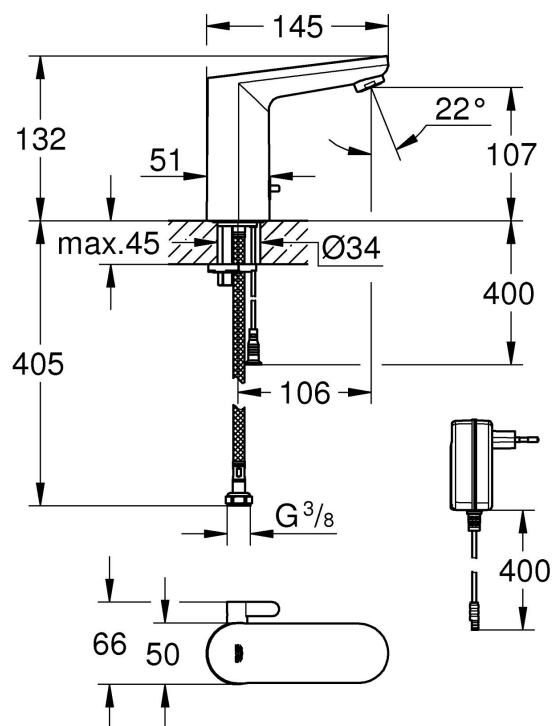

Flow Chart

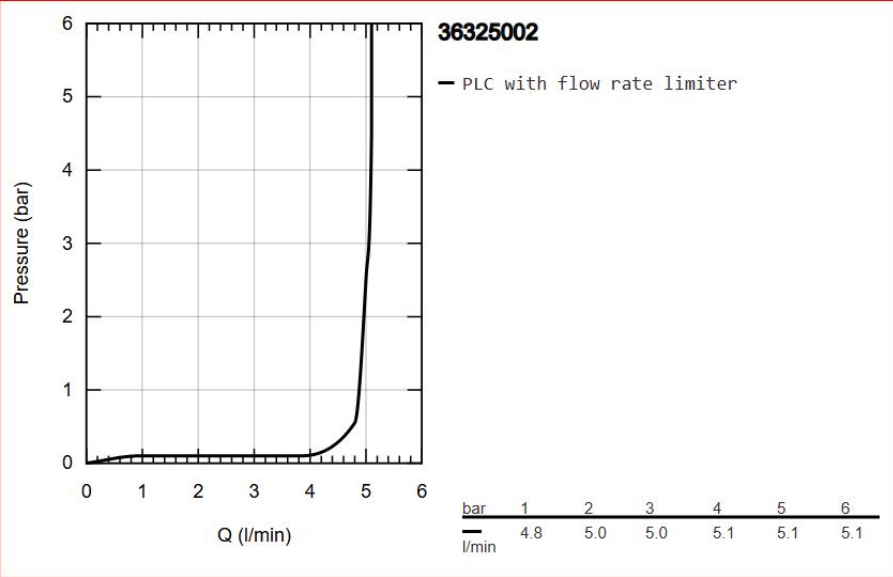

MOT



GROHE Water Saving



2 Year Warranty