

Grohe Essence Single-Lever Sink Mixer 1/2"

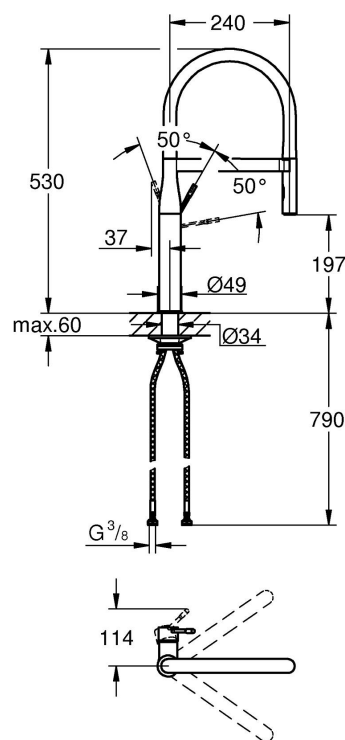

Range:	Essence
Description:	monobloc installation 28 mm ceramic cartridge with GROHE SilkMove flow strainer with integrated temperature limiter professional spray with flexible, hygienic GROHFlexx kitchen santoprene hose diverter: laminar spray/SpeedClean shower jet automatic return to laminar spray metal spray GROHE Magnetic Docking guarantees easy retraction and smooth docking of the spray head back to the starting position swivel spout swivel area 360° protected against backflow flexible connection hoses metal fixation set maximum flow rate (at 3 bar): 8 l/min professional edition
Product Code:	30503KF0
ERP Code:	30503KF0
Barcode:	4005176782695
Product Features:	GROHE SilkMove, 20 Year Warranty
Dimensions:	(l) 690mm x (w) 340mm x (h) 65mm
Package Weight:	3.755
CAD3D:	Download

Product Images



Flow Chart

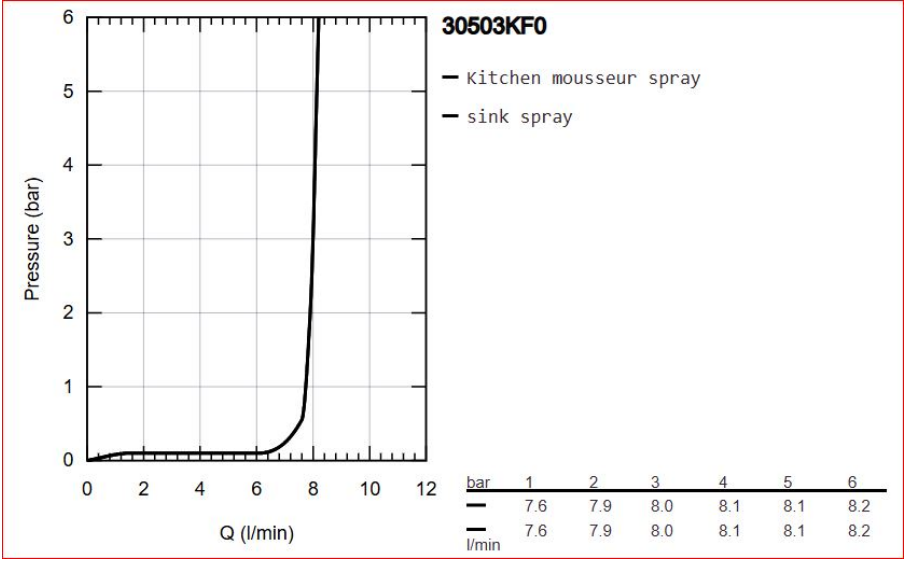

MOT



GROHE SilkMove



20 Year Warranty