

Grohe Essence Basin Mixer 1/2" S-Size

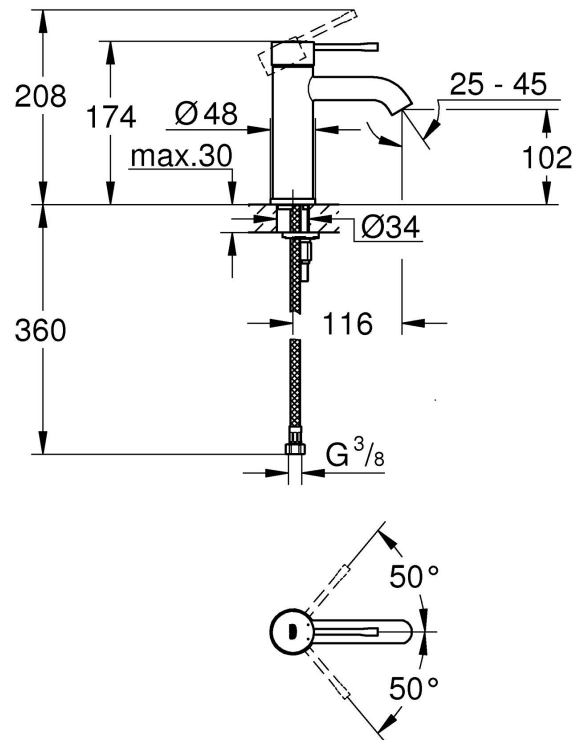

Range:	Essence
Description:	The compact GROHE Essence single-lever basin mixer in stylish phantom black – a durable designer tap with smart and sustainable features - monobloc installation, metal lever, 28 mm ceramic cartridge , with GROHE SilkMove, with temperature limiter, GROHE Water Saving - Less water, perfect flow, maximum flow rate (at 3 bar): 5 l/min, GROHE AquaGuide adjustable mousseur, GROHE FastFixation Plus installation system, smooth body, flexible connection hoses, professional edition
Product Code:	24172KF1
ERP Code:	24172KF1
Barcode:	4005176782398
Product Features:	GROHE SilkMove, 20 Year Warranty, GROHE Water Saving, 5 Years on coating
Dimensions:	(l) 380mm x (w) 190mm x (h) 70mm
Package Weight:	1.29
CAD3D:	Download

Product Images



Flow Chart

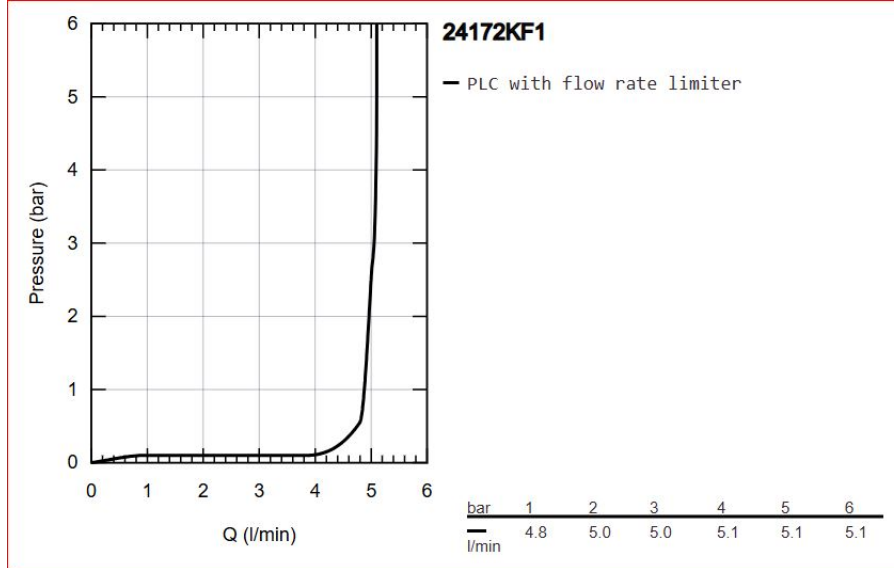

MOT



GROHE SilkMove



GROHE Water Saving



20 Year Warranty