

Grohe Arena Aqua Tiles Flush Plate With Silk Motion Technology



Range: Arena Aqua Tiles

Description: Minimalist design and perfect performance – it's the GROHE Arena Aqua Tiles flush plate in phantom black - for dual flush actuation, for pneumatic drop valve AV1, for vertical installation, 160 x 201 mm, material: ABS, GROHE Water Saving - Less water, perfect flow, for combination with Rapid SL and Uniset with GD 2 cistern, slim cistern and 80 mm cistern, 6V lithium battery, type CR-P2, battery lifetime: 4 years for a 3 person household (approx. 17000 actuations), battery status warning, auto flush, cleaning mode, for mains supply please order transformer 100 686 9990

Product Code: 104645KF00

ERP Code: 104645KF00

Barcode: 4067393039297

Product Features: 5 Year Warranty

Dimensions: (l) 265mm x (w) 200mm x (h) 53mm

Package Weight: 0.66

CAD3D: [Download](#)

Product Images

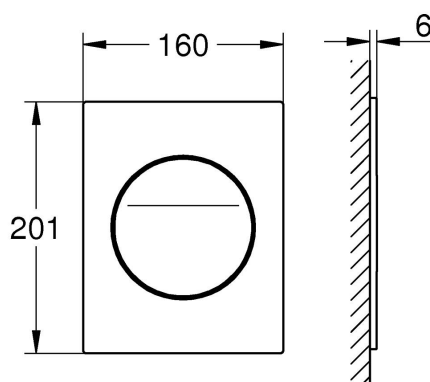

MOT



5 Year Warranty