

Cobra Zambezi Sink Mixer Low Level Spout



Range: Zambezi

Description: Zambezi pillar type sink mixer low level spout single lever flow rate restricted to 6.2 ltrs/min, g1/2 female connection ends chrome plated Care & Maintenance - Ensure your product does not come into contact with any lubricants during installation. Chrome plated, matte black and any colour finishes should be wiped with warm soapy water and a soft cloth or sponge. Rinse, then dry and buff with a dry soft cloth. Under no circumstances must any detergents containing hydrochloric acids or abrasives including cream cleansers be used. Do not use abrasive cleaning materials such as scourers. Should your product have an aerator at the water outlet, it should be checked and cleaned regularly.

Product Code: ZM-973

ERP Code: 1105840000

Barcode: 6002194159520

Product Features: Cobra PureShine, Cobra EcoMind, Cobra TeamAssist, 10 Year Warranty, DZR Brass, JaswicApproved

Dimensions: (l) 290mm x (w) 190mm x (h) 60mm

Package Weight: 0.6

Product Images

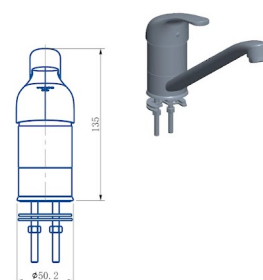
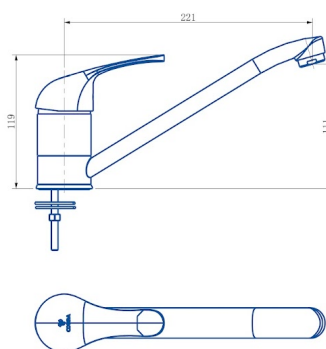

Flow Chart

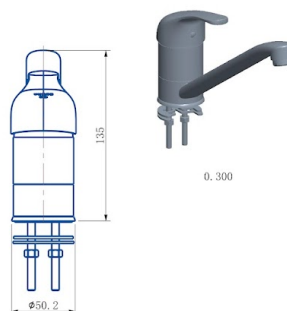
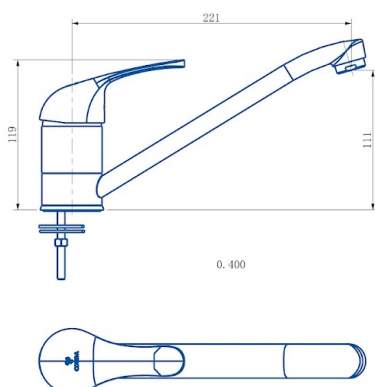



Cobra TeamAssist



Cobra EcoMind



DZR Brass



Cobra PureShine



10 Year Warranty



JaswicApproved