

Cobra Seine Brushed Gun Grey Sink Mixer

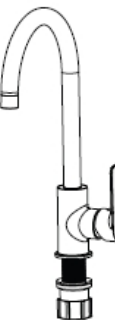

Range:	Seine Brushed Gun Grey
Description:	Seine single lever sink mixer. Pillar type with single hole. Manufactured with plastic internal waterways. Items are coated using a physical vapour deposition (PVD) process. 15mm flexi-connection ends. Fitted with Neoperl aerator. Convenient tube fixing set. Carries a 10 year warranty on functionality, 2 year warranty on brushed gun grey coating. Care & Maintenance - Ensure your product does not come into contact with any lubricants during installation. Chrome plated, matte black and any colour finishes should be wiped with warm soapy water and a soft cloth or sponge. Rinse, then dry and buff with a dry soft cloth. Under no circumstances must any detergents containing hydrochloric acids or abrasives including cream cleansers be used. Do not use abrasive cleaning materials such as scourers. Should your product have an aerator at the water outlet, it should be checked and cleaned regularly.
Product Code:	SE-970BGG
ERP Code:	1011692660
Barcode:	6002194153382
Product Features:	Cobra FeatherTouch, Cobra TeamAssist, 10 Year Warranty, 2 years on coating, New Seine Colours
Dimensions:	(l) 450mm x (w) 70mm x (h) 250mm
Package Weight:	1.3

Product Images

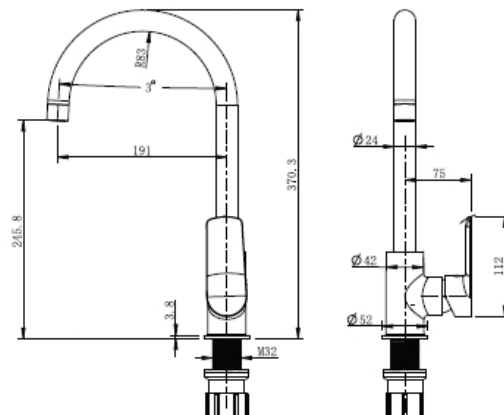

Flow Chart

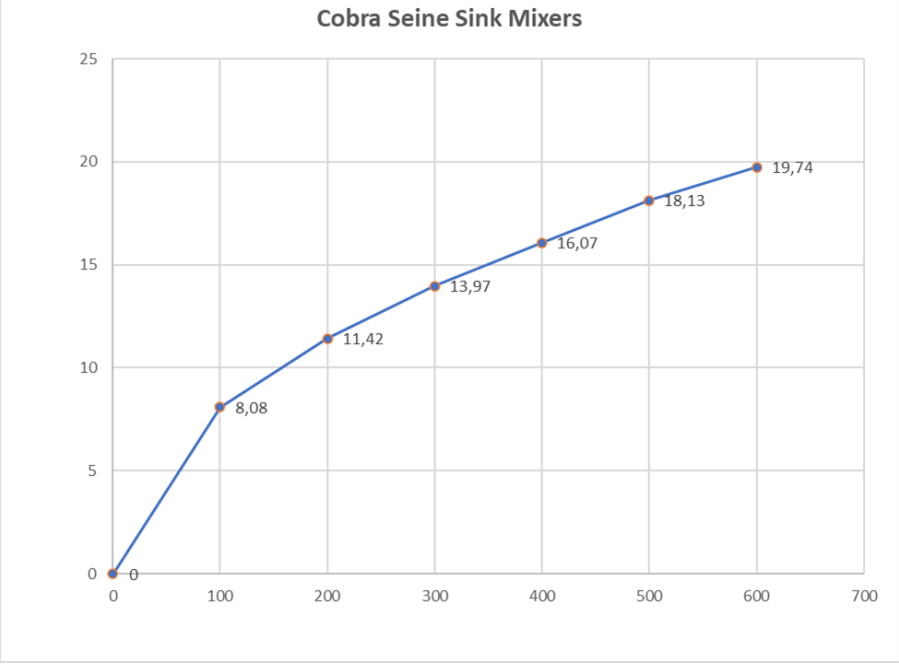

MOT



Cobra TeamAssist



Cobra FeatherTouch



10 Year Warranty



2 years on coating