

## Cobra Kwikflo PCV Polymer 400kPa

**Range:** Kwikflo

**Description:** Non-restrictive design for high flow rate ensuring optimal terminal fitting performance. DZR brass ball used for enhanced shut-off strength under full flow pressure. 360 revolving isolating valve and expansion outlet for flexibility and ease of installation. Body made of premium Nylon 66 polymer material including the isolating lever, temperature rating 60-100 degrees, UV stable body. JASWIC certified. SANS 198 compliant.



**Product Code:** PA8-332

**ERP Code:** 1057789990

Barcode: 6002194158288

<b>Product</b>	Cobra TeamAssist, 2 Year Warranty, JaswicApproved
----------------	---------------------------------------------------

### Features:

**Dimensions:** (l) 210mm x (w) 55mm x (h) 185mm

**Package Weight:** 0.66

## Product Images

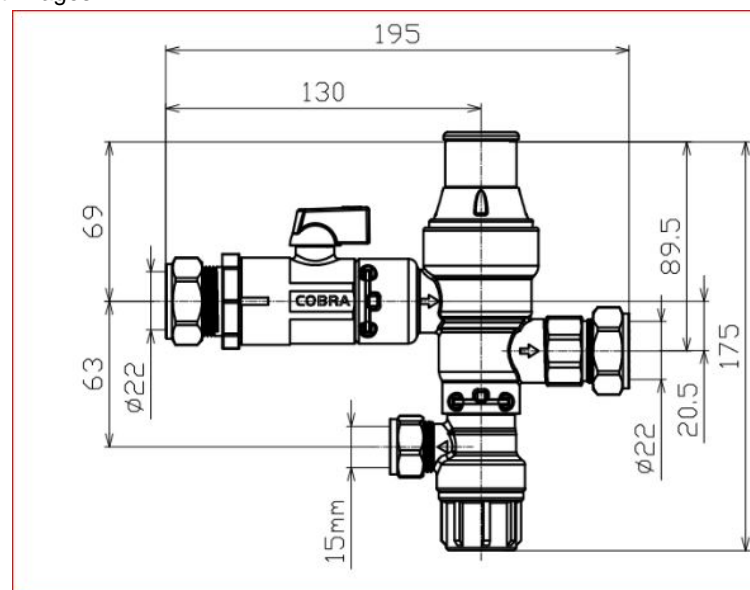
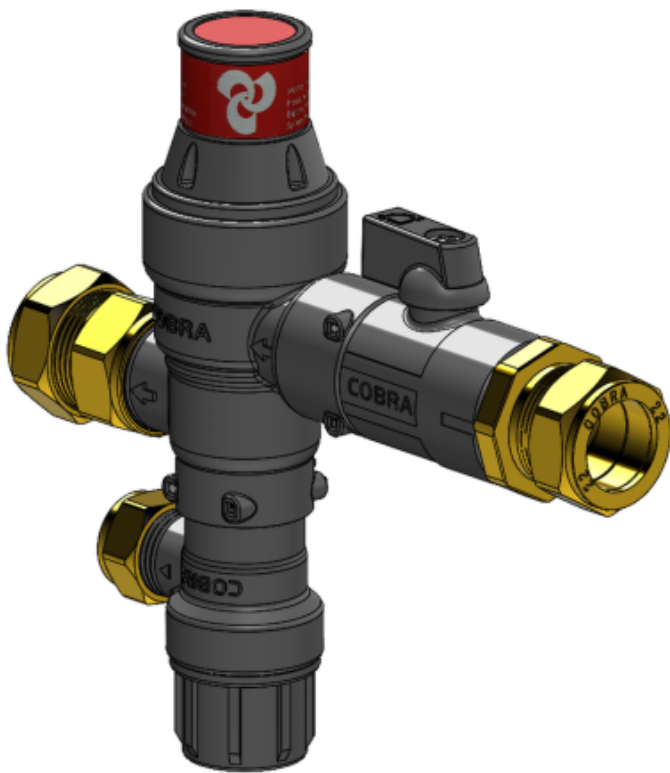

### Flow Chart

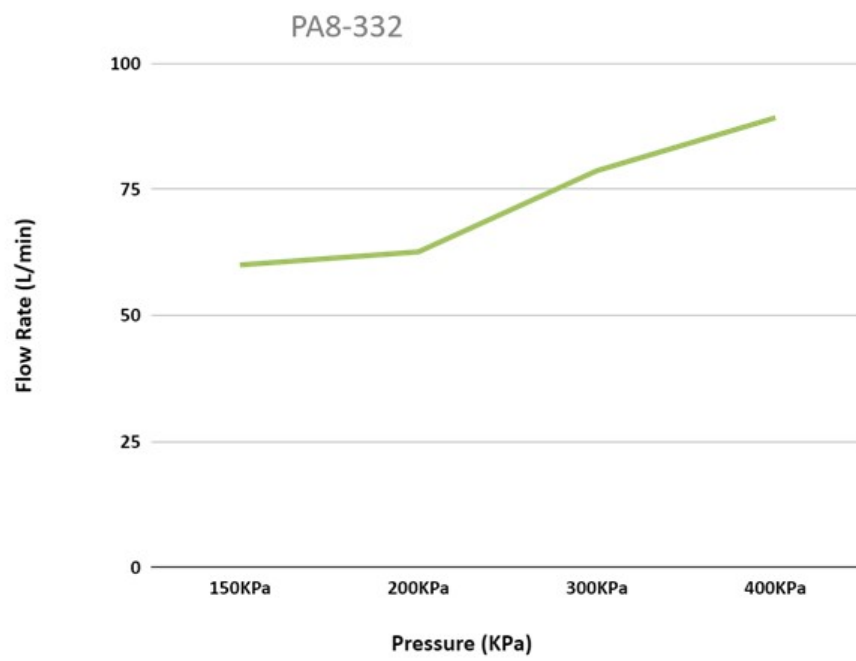

MOT



2 Year Warranty



JaswicApproved



Cobra TeamAssist