

Cobra Cobra Angle Valve Adaptor



Range: Cobra

Description: Adaptor allowing for an angle valve with a 9/16-24 UNEF connection to connect to a Cobra single lever basin or sink mixer manufactured with G1/2 flexible connectors. For South American installations. Manufactured with Cobra DefenZR durable dezincification-resistant brass. Plated with Cobra PureShine chrome plating for long-lasting shine. Access to Cobra TeamAssist technical team. 20-year warranty.

Product Code: C-AV/ADAP9/16F-1/2M

ERP Code: 1034080000

Barcode: 6002194156697

Product Features: Cobra PureShine, DZR Brass, TeamAssist, 20 Years

Dimensions: (l) 40mm x (w) 40mm x (h) 40mm

Package Weight: 0.033

Product Images

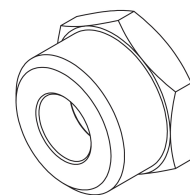
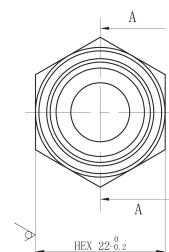
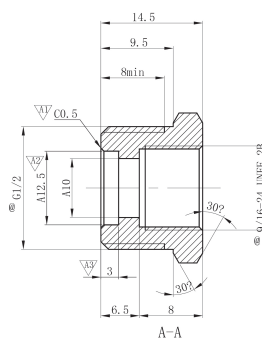

MOT



DZR Brass



Cobra PureShine