

Cobra Seine Brushed Gun Grey Waste Basin Click no slot

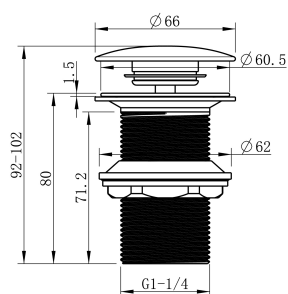

Range:	Seine Brushed Gun Grey
Description:	Round click-open basin waste for basins without an overflow. Unslotted, with integral plug. 62mm Ø flange, 78mm long shank. 1 1/4" BSP Male iron connection end. Items are coated using a physical vapour deposition (PVD) process. Carries a 20 year warranty on functionality, 2 year warranty on brushed gun grey coating. Care & Maintenance - Ensure your product does not come into contact with any lubricants during installation. Chrome plated, matte black and any colour finishes should be wiped with warm soapy water and a soft cloth or sponge. Rinse, then dry and buff with a dry soft cloth. Under no circumstances must any detergents containing hydrochloric acids or abrasives including cream cleansers be used. Do not use abrasive cleaning materials such as scourers. Should your product have an aerator at the water outlet, it should be checked and cleaned regularly.
Product Code:	302-32NS-BGG
ERP Code:	1011772660
Barcode:	6002194153474
Product Features:	Cobra TeamAssist, 20 Year Warranty, 2 years on coating, New Seine Colours
Dimensions:	(l) 125mm x (w) 80mm x (h) 80mm
Package Weight:	0.36

Product Images

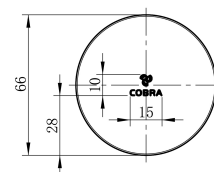

MOT



Cobra TeamAssist



20 Year Warranty



2 years on coating