

# Cobra Zambezi Basin Mixer Standard

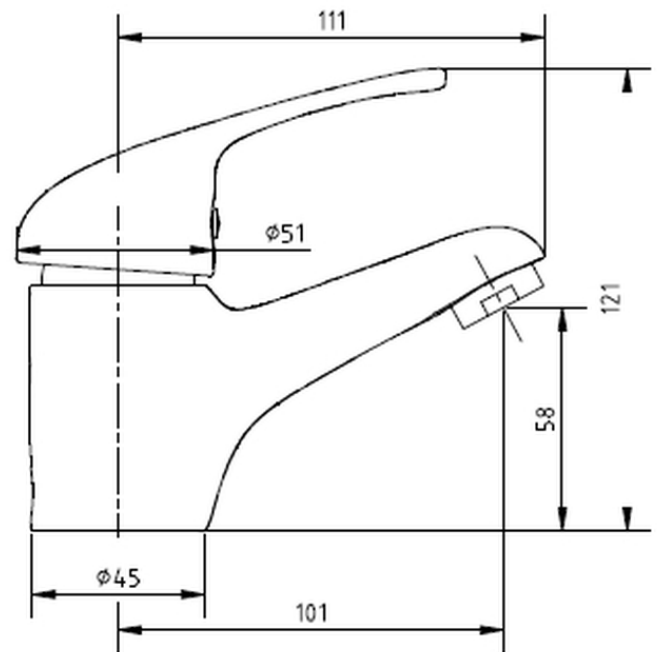

<b>Range:</b>	Zambezi
<b>Description:</b>	Zambezi pillar type single lever basin mixer flow rate restricted to 3.6 ltrs/ min G1/2 female connection ends chrome. Care & Maintenance - Ensure your product does not come into contact with any lubricants during installation. Chrome plated, matte black and any colour finishes should be wiped with warm soapy water and a soft cloth or sponge. Rinse, then dry and buff with a dry soft cloth. Under no circumstances must any detergents containing hydrochloric acids or abrasives including cream cleansers be used. Do not use abrasive cleaning materials such as scourers. Should your product have an aerator at the water outlet, it should be checked and cleaned regularly.
<b>Product Code:</b>	ZM-951
<b>ERP Code:</b>	FBN1D1ZM-0GT0425
<b>Barcode:</b>	6002194003557
<b>Product Features:</b>	Cobra EcoMind, Cobra TeamAssist, Cobra Genuine, 10 Year Warranty, Economy, JaswicApproved
<b>Dimensions:</b>	(l) 180mm x (w) 170mm x (h) 90mm
<b>Package Weight:</b>	0.94

Product Images



Flow Chart

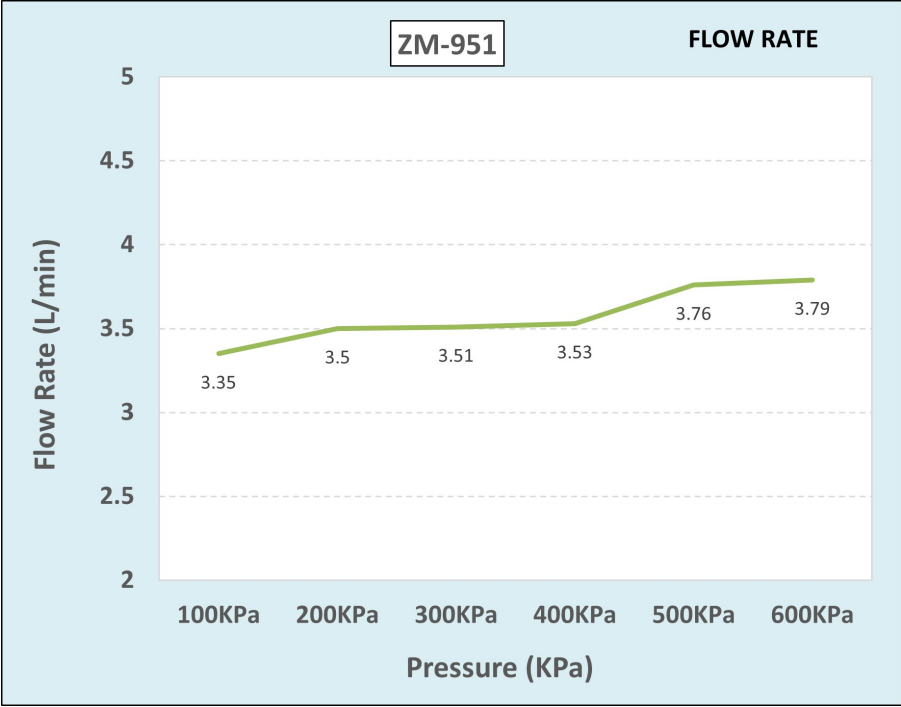

MOT



Economy



Cobra EcoMind



Cobra TeamAssist



Cobra Genuine



10 Year Warranty



JasvicApproved