

Cobra Cobra Safety Valve 400kPa 20mm

Range: Cobra

Description: TP master. With locking nut and silicon sealing washer. 3/4BSP male iron geyser connection. 22mm compression relief outlet. System pressure 400kPa.

Product Code: PB1-43/N

ERP Code: FTPSV340-7FT01

Barcode: 6002194024712

Product Features: Cobra TeamAssist, SABS Approved, DZR Brass, 2 Year Warranty

Dimensions: (l) 190mm x (w) 120mm x (h) 80mm

Package Weight: 0.36



Product Images

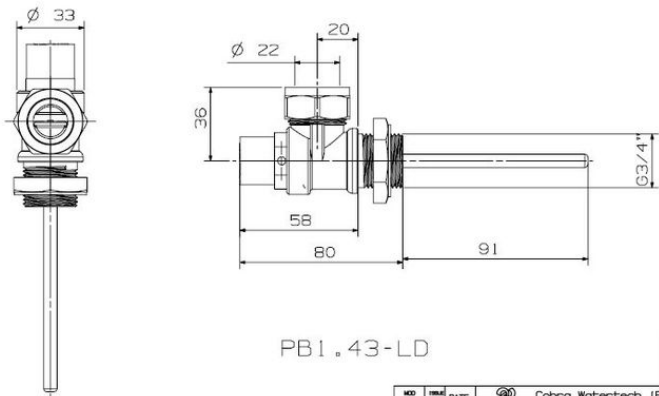

PB1-43-LD

REV	DATE	DESCRIPTION
00	2007/02/05	Initial release
01	2007/02/05	Revised drawing
02	2007/02/05	Revised drawing
03	2007/02/05	Revised drawing
04	2007/02/05	Revised drawing
05	2007/02/05	Revised drawing
06	2007/02/05	Revised drawing
07	2007/02/05	Revised drawing
08	2007/02/05	Revised drawing
09	2007/02/05	Revised drawing
10	2007/02/05	Revised drawing
11	2007/02/05	Revised drawing
12	2007/02/05	Revised drawing
13	2007/02/05	Revised drawing
14	2007/02/05	Revised drawing
15	2007/02/05	Revised drawing
16	2007/02/05	Revised drawing
17	2007/02/05	Revised drawing
18	2007/02/05	Revised drawing
19	2007/02/05	Revised drawing
20	2007/02/05	Revised drawing
21	2007/02/05	Revised drawing
22	2007/02/05	Revised drawing
23	2007/02/05	Revised drawing
24	2007/02/05	Revised drawing
25	2007/02/05	Revised drawing
26	2007/02/05	Revised drawing
27	2007/02/05	Revised drawing
28	2007/02/05	Revised drawing
29	2007/02/05	Revised drawing
30	2007/02/05	Revised drawing
31	2007/02/05	Revised drawing
32	2007/02/05	Revised drawing
33	2007/02/05	Revised drawing
34	2007/02/05	Revised drawing
35	2007/02/05	Revised drawing
36	2007/02/05	Revised drawing
37	2007/02/05	Revised drawing
38	2007/02/05	Revised drawing
39	2007/02/05	Revised drawing
40	2007/02/05	Revised drawing
41	2007/02/05	Revised drawing
42	2007/02/05	Revised drawing
43	2007/02/05	Revised drawing
44	2007/02/05	Revised drawing
45	2007/02/05	Revised drawing
46	2007/02/05	Revised drawing
47	2007/02/05	Revised drawing
48	2007/02/05	Revised drawing
49	2007/02/05	Revised drawing
50	2007/02/05	Revised drawing
51	2007/02/05	Revised drawing
52	2007/02/05	Revised drawing
53	2007/02/05	Revised drawing
54	2007/02/05	Revised drawing
55	2007/02/05	Revised drawing
56	2007/02/05	Revised drawing
57	2007/02/05	Revised drawing
58	2007/02/05	Revised drawing
59	2007/02/05	Revised drawing
60	2007/02/05	Revised drawing
61	2007/02/05	Revised drawing
62	2007/02/05	Revised drawing
63	2007/02/05	Revised drawing
64	2007/02/05	Revised drawing
65	2007/02/05	Revised drawing
66	2007/02/05	Revised drawing
67	2007/02/05	Revised drawing
68	2007/02/05	Revised drawing
69	2007/02/05	Revised drawing
70	2007/02/05	Revised drawing
71	2007/02/05	Revised drawing
72	2007/02/05	Revised drawing
73	2007/02/05	Revised drawing
74	2007/02/05	Revised drawing
75	2007/02/05	Revised drawing
76	2007/02/05	Revised drawing
77	2007/02/05	Revised drawing
78	2007/02/05	Revised drawing
79	2007/02/05	Revised drawing
80	2007/02/05	Revised drawing
81	2007/02/05	Revised drawing
82	2007/02/05	Revised drawing
83	2007/02/05	Revised drawing
84	2007/02/05	Revised drawing
85	2007/02/05	Revised drawing
86	2007/02/05	Revised drawing
87	2007/02/05	Revised drawing
88	2007/02/05	Revised drawing
89	2007/02/05	Revised drawing
90	2007/02/05	Revised drawing
91	2007/02/05	Revised drawing
92	2007/02/05	Revised drawing
93	2007/02/05	Revised drawing
94	2007/02/05	Revised drawing
95	2007/02/05	Revised drawing
96	2007/02/05	Revised drawing
97	2007/02/05	Revised drawing
98	2007/02/05	Revised drawing
99	2007/02/05	Revised drawing
100	2007/02/05	Revised drawing

MOT



Cobra TeamAssist



2 Year Warranty



DZR Brass



SABS Approved