

Cobra Cobra Shower arm



Range: Cobra

Description: Shower arm with wall flange, chrome-plated. 110mm throw. G1/2M X G1/2M Brass construction

Product Code: P-024

ERP Code: FSACAR10-0GTPP0150

Barcode: 6002194048107

Product Features: Cobra PureShine, Cobra TeamAssist, Cobra Genuine, 5 Year Warranty

Dimensions: (l) 200mm x (w) 250mm x (h) 70mm

Package Weight: 0.12

Product Images

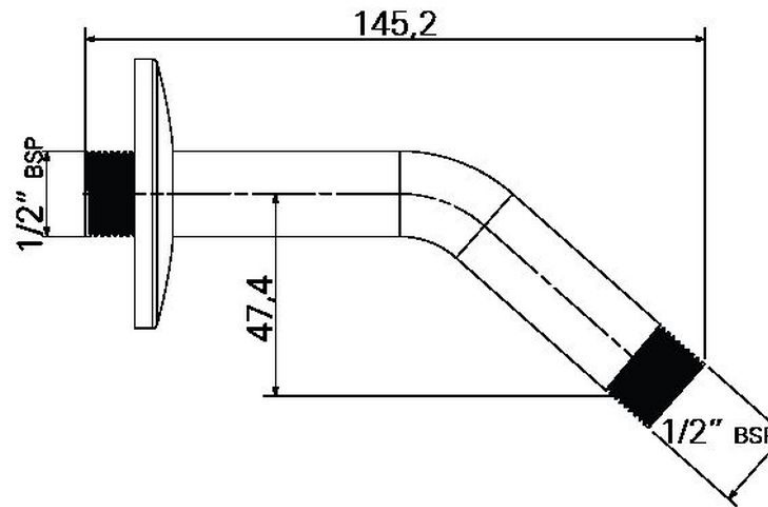

MOT



Cobra PureShine



Cobra TeamAssist



Cobra Genuine



5 Year Warranty