

Cobra Cobra Stop Tap Demand 15mm



Range: Cobra

Description: Demand exposed stop tap, chrome. Includes: pushbutton, and 1/2 BSP female inlets. An excellent water-saving product, and can be easily installed in place of conventional taps. SANS 1808-66. Care & Maintenance - Ensure your product does not come into contact with any lubricants during installation. Chrome plated, matte black and any colour finishes should be wiped with warm soapy water and a soft cloth or sponge. Rinse, then dry and buff with a dry soft cloth. Under no circumstances must any detergents containing hydrochloric acids or abrasives including cream cleansers be used. Do not use abrasive cleaning materials such as scourers. Should your product have an aerator at the water outlet, it should be checked and cleaned regularly.

Product Code: KM2-302/N

ERP Code: FSTAF1DT-0GT01

Barcode: 6002194032755

Product Features: 2 Year Warranty

Dimensions: (l) 150mm x (w) 130mm x (h) 60mm

Package Weight: 0.4

Product Images

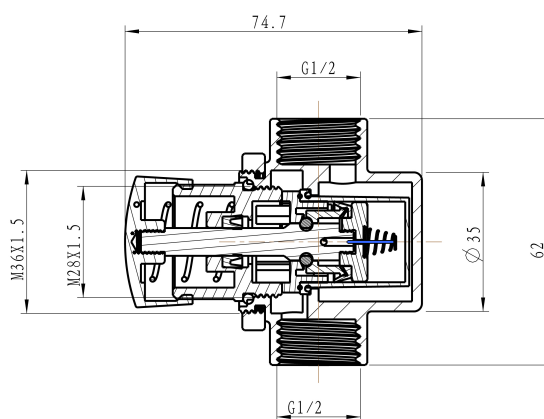

Flow Chart

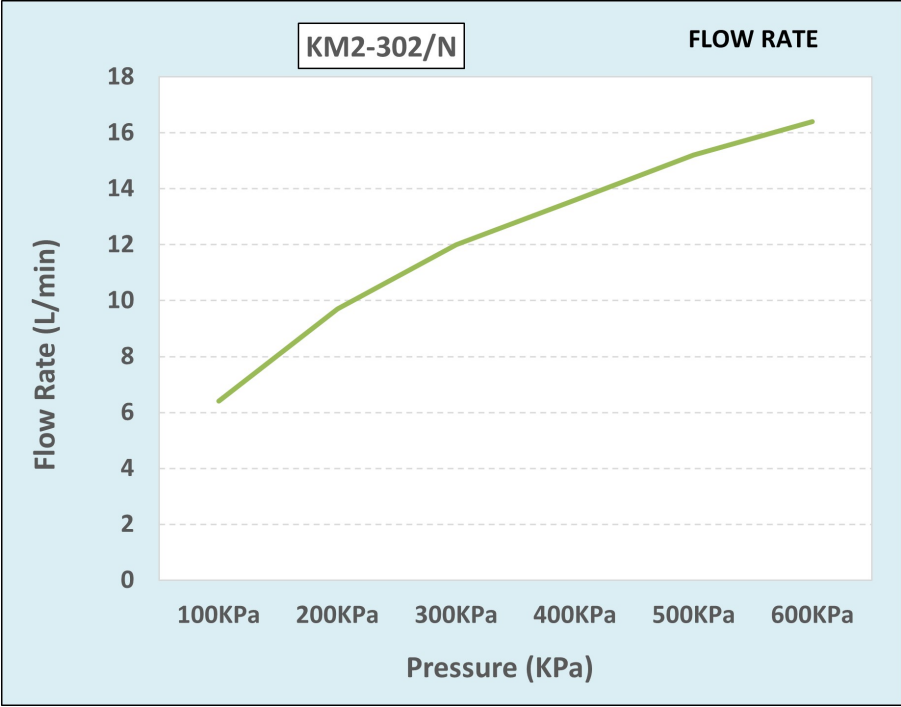

MOT



2 Year Warranty