

Cobra Cobra Spout Metering

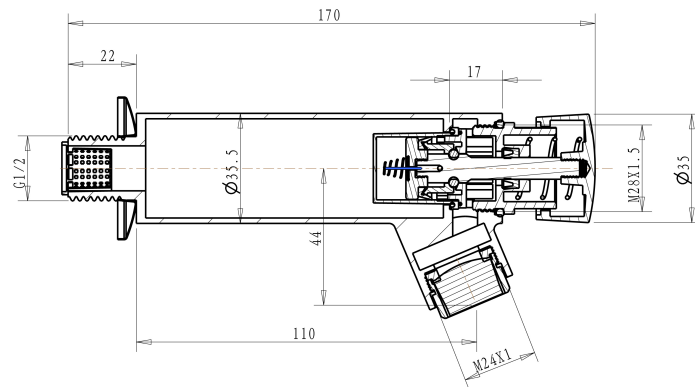

Range:	Cobra
Description:	Wall type. Non hold open, self closing. With wall flange and flow controller. 1/2BSP male iron connection end. Flow cycle 1-20 seconds. Care & Maintenance - Ensure your product does not come into contact with any lubricants during installation. Chrome plated, matte black and any colour finshes should be wiped with warm soapy water and a soft cloth or sponge. Rinse, then dry and buff with a dry soft cloth. Under no circumstances must any detergents containing hydrochloric acids or abrasives including cream cleansers be used. Do not use abrasive cleaning materials such as scourers. Should your product have an aerator at the water outlet, it should be checked and cleaned regularly.
Product Code:	KM066WT-114/N
ERP Code:	FSPT21MT-0GT01
Barcode:	6002194032748
Product Features:	Cobra PureShine, Cobra EcoMind, Cobra TeamAssist, Cobra Genuine, 2 Year Warranty
Dimensions:	(l) 210mm x (w) 170mm x (h) 50mm
Package Weight:	0.6

Product Images



Flow Chart

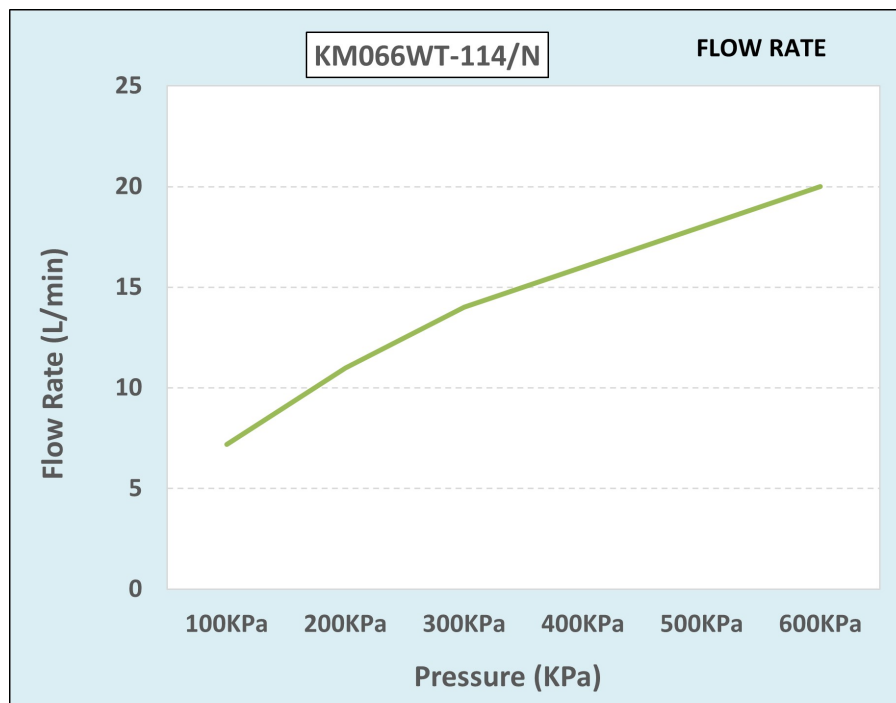

MOT



Cobra PureShine



Cobra EcoMind



Cobra TeamAssist



Cobra Genuine



2 Year Warranty