

Cobra Flush Junior Toilet Flush Pipe



Range: Flush Junior

Description: Bent, for junior flushmaster toilet flushvalves. 25.4mm diameter, 640mm vertical length, 140mm horizontal length. Care & Maintenance - Ensure your product does not come into contact with any lubricants during installation. Chrome plated, matte black and any colour finishes should be wiped with warm soapy water and a soft cloth or sponge. Rinse, then dry and buff with a dry soft cloth. Under no circumstances must any detergents containing hydrochloric acids or abrasives including cream cleansers be used. Do not use abrasive cleaning materials such as scourers. Should your product have an aerator at the water outlet, it should be checked and cleaned regularly.

Product Code: FJT1-1/N

ERP Code: FFUUPTFJ-0GT01

Barcode: 6002194018575

Product Features: Cobra PureShine, Cobra TeamAssist, 2 Year Warranty

Dimensions: (l) 670mm x (w) 170mm x (h) 50mm

Package Weight: 0.58

Product Images

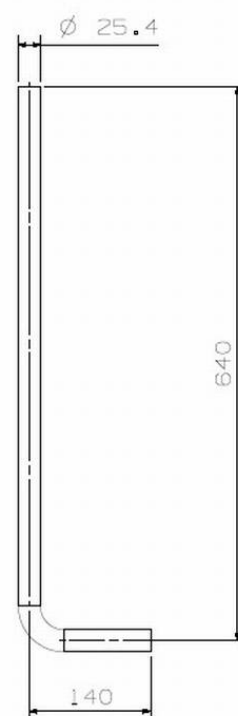

MOT



Cobra PureShine



Cobra TeamAssist



2 Year Warranty