

Cobra Flush Junior Toilet Flush Valve



Range: Flush Junior

Description: Concealed back entry. Institutional version. Non-hold open feature. With integral vacuum breaker, and 'Ball O Stop' control inlet. Capillary reducing coupling outlet for 28mm copper flushpipes, Through the wall/vandal resistant guide tube, pushrod and captive linkage, pushbutton assembly and rubber pan connector. 3/4BSP female iron connection end. CP pushbutton assembly. Recommended optimum design pressures: inlet flow pressure 150 - 500kPa: Maximum system pressure 600kPa. Care & Maintenance - Ensure your product does not come into contact with any lubricants during installation. Chrome plated, matte black and any colour finishes should be wiped with warm soapy water and a soft cloth or sponge. Rinse, then dry and buff with a dry soft cloth. Under no circumstances must any detergents containing hydrochloric acids or abrasives including cream cleansers be used. Do not use abrasive cleaning materials such as scourers. Should your product have an aerator at the water outlet, it should be checked and cleaned regularly.

Product Code: FJ4-203PR/N

ERP Code: FFU6STFJ-0GT01

Barcode: 6002194033059

Product Features: Cobra EcoMind, Cobra TeamAssist, Cobra Genuine, DZR Brass, 2 Year Warranty, JaswicApproved

Dimensions: (l) 430mm x (w) 230mm x (h) 80mm

Package Weight: 2.15

Product Images

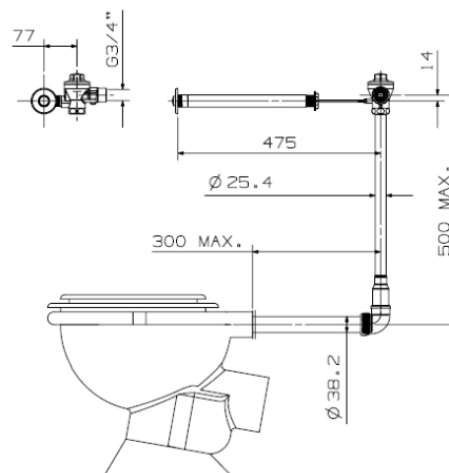

MOT



Cobra EcoMind



Cobra TeamAssist



Cobra Genuine



2 Year Warranty



DZR Brass



JaswicApproved