

Cobra Cobratron Urinal Flush Valve



Range: Cobratron

Description: Cobratron sensor-activated, exposed urinal flush valve, chrome. Includes: 1/2 BSP male inlet, and super capacitor power supply. 12mm to 15mm connection adaptor required. Use flushpipe FJT5-5/N or FJT5-4/N Care & Maintenance - Ensure your product does not come into contact with any lubricants during installation. Chrome plated, matte black and any colour finishes should be wiped with warm soapy water and a soft cloth or sponge. Rinse, then dry and buff with a dry soft cloth. Under no circumstances must any detergents containing hydrochloric acids or abrasives including cream cleansers be used. Do not use abrasive cleaning materials such as scourers. Should your product have an aerator at the water outlet, it should be checked and cleaned regularly.

Product Code: EL-3004

ERP Code: FELURVCC-0GT0176

Barcode: 6002194063384

Product Features: Cobra PureShine, Cobra EcoMind, Cobra TeamAssist, Cobra Genuine, Projects, Public Spaces, Touchfree, 2 Year Warranty, Touchless Valves

Dimensions: (l) 180mm x (w) 150mm x (h) 60mm

Package Weight: 1.06

Product Images

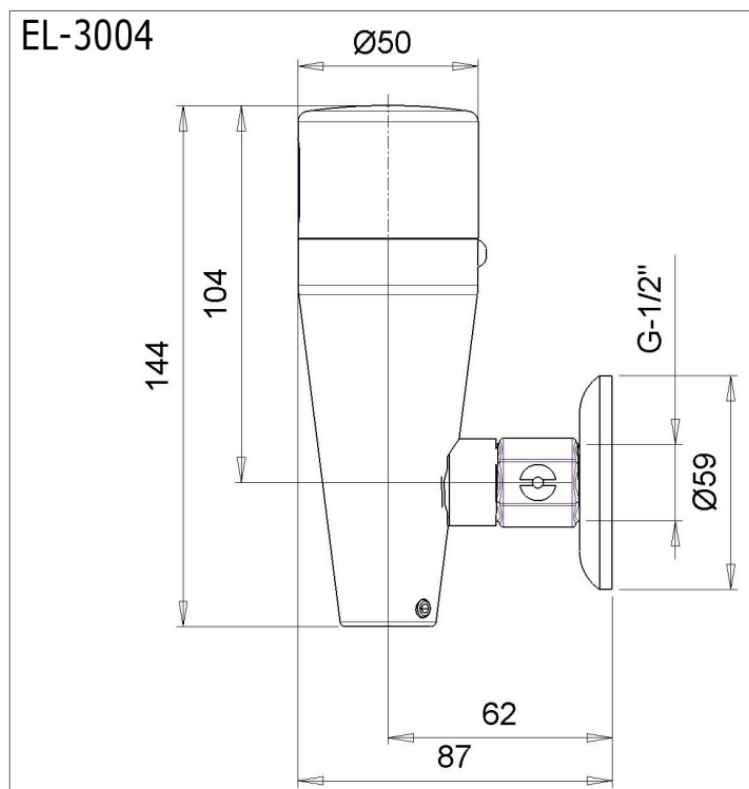

Flow Chart

Flow Chart:

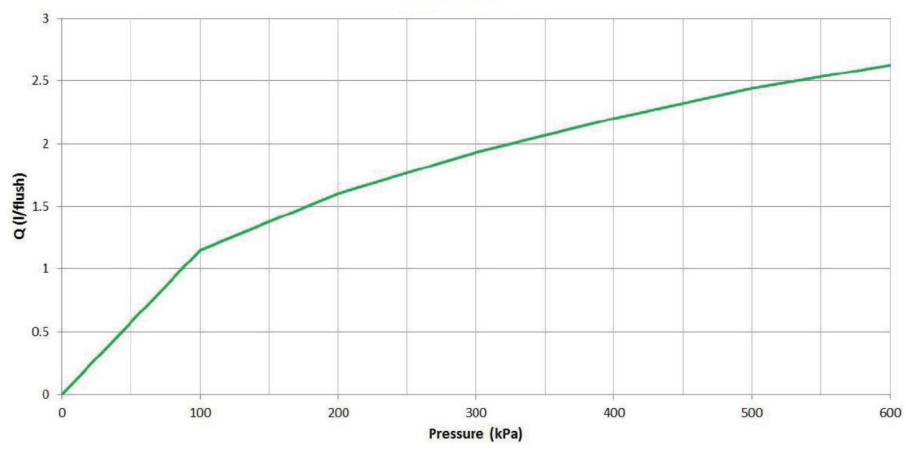

MOT



Cobra PureShine



Cobra EcoMind



Cobra TeamAssist



Cobra Genuine



Touchfree



Projects



Public Spaces



2 Year Warranty