

Cobra Breathe Basin Mixer Standard

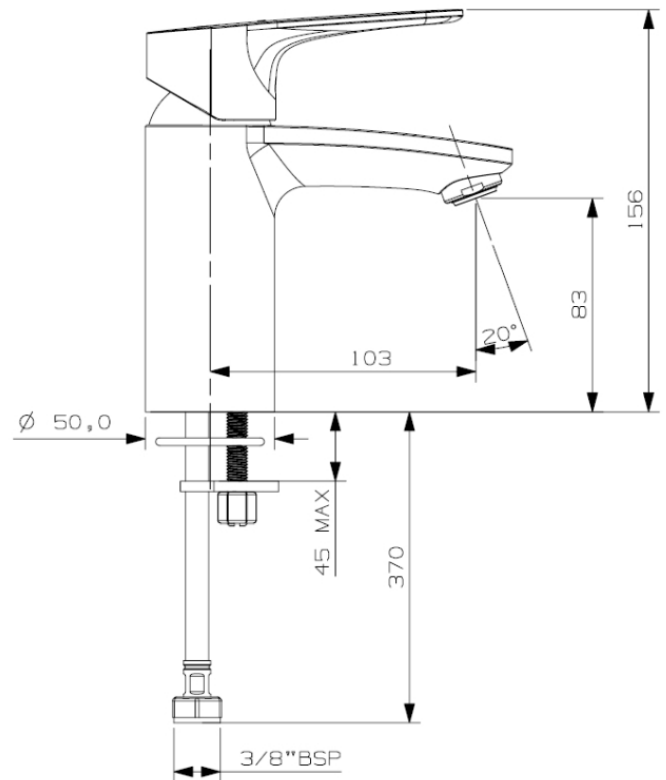

Range:	Breathe
Description:	Breathe basin mixer, single lever plain, chrome. Flow restricted. Includes: 3/8 BSP, 370mm long, female inlets. Care & Maintenance - Ensure your product does not come into contact with any lubricants during installation. Chrome plated, matte black and any colour finishes should be wiped with warm soapy water and a soft cloth or sponge. Rinse, then dry and buff with a dry soft cloth. Under no circumstances must any detergents containing hydrochloric acids or abrasives including cream cleansers be used. Do not use abrasive cleaning materials such as scourers. Should your product have an aerator at the water outlet, it should be checked and cleaned regularly.
Product Code:	BR-951
ERP Code:	FBL1D1Y6-0GT0383
Barcode:	6002194018209
Product Features:	Cobra PureShine, Cobra EcoMind, Cobra FeatherTouch, Cobra TeamAssist, Cobra Genuine, DZR Brass, 20 Year Warranty
Dimensions:	(l) 390mm x (w) 170mm x (h) 70mm
Package Weight:	1.46
CAD3D:	Download

Product Images



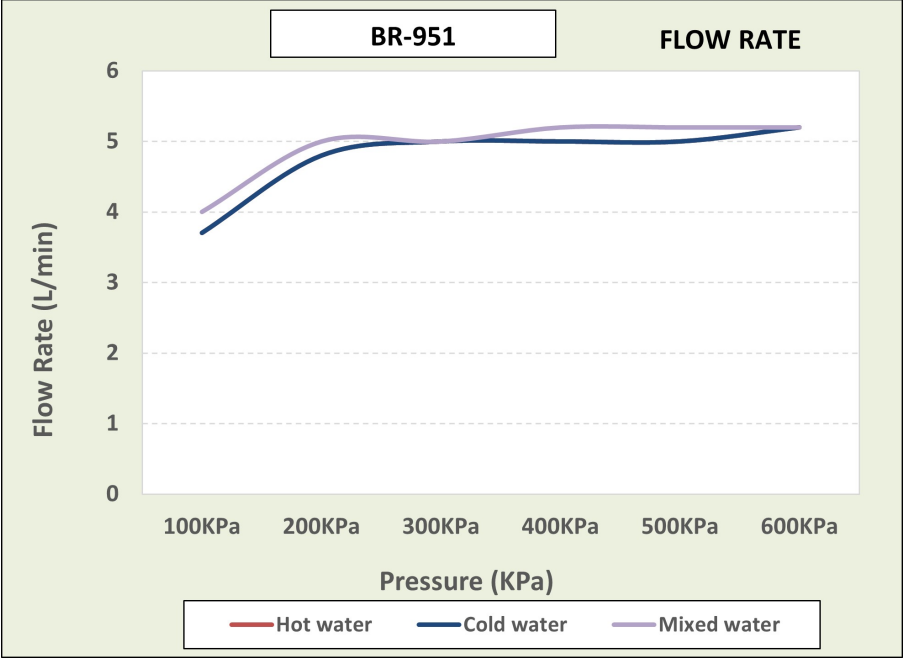

Flow Chart





MOT

- 

20 Year Warranty
- 

Cobra PureShine
- 

Cobra EcoMind
- 

DZR Brass
- 

Cobra FeatherTouch
- 

Cobra TeamAssist
- 

Cobra Genuine