

# Cobra Seine Matte Black Basin Mixer Standard

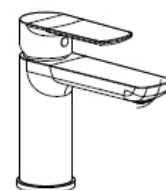

<b>Range:</b>	Seine Matte Black
<b>Description:</b>	Seine single lever standard basin mixer. Pillar type with single hole. Manufactured with dezincification resistant (DZR) brass. Matt black items are coated using an electrophoresis coating process resulting in a thickness of between 20 - 25µm. 15mm flexi-connection ends. 35mm ceramic disc cartridge. Fitted with Neoperl aerator with a flow rate = 7 litres/min at 300 kPa. Convenient tube fixing set. 2 year warranty on black coating. Jaswic Approved Care & Maintenance - Ensure your product does not come into contact with any lubricants during installation. Chrome plated, matte black and any colour finishes should be wiped with warm soapy water and a soft cloth or sponge. Rinse, then dry and buff with a dry soft cloth. Under no circumstances must any detergents containing hydrochloric acids or abrasives including cream cleansers be used. Do not use abrasive cleaning materials such as scourers. Should your product have an aerator at the water outlet, it should be checked and cleaned regularly.
<b>Product Code:</b>	5819EB/N
<b>ERP Code:</b>	FBN1D1BO-5EP01
<b>Barcode:</b>	6002194052272
<b>Product Features:</b>	Cobra FeatherTouch, Cobra TeamAssist, 10 Year Warranty, DZR Brass, New Seine Ebony, 2 years on coating, New Seine Colours
<b>Dimensions:</b>	(l) 280mm x (w) 180mm x (h) 70mm
<b>Package Weight:</b>	1.34

Product Images

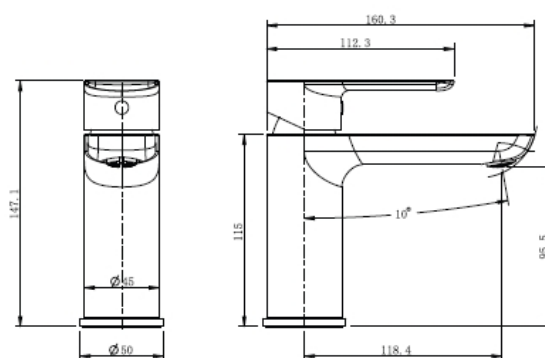

Flow Chart

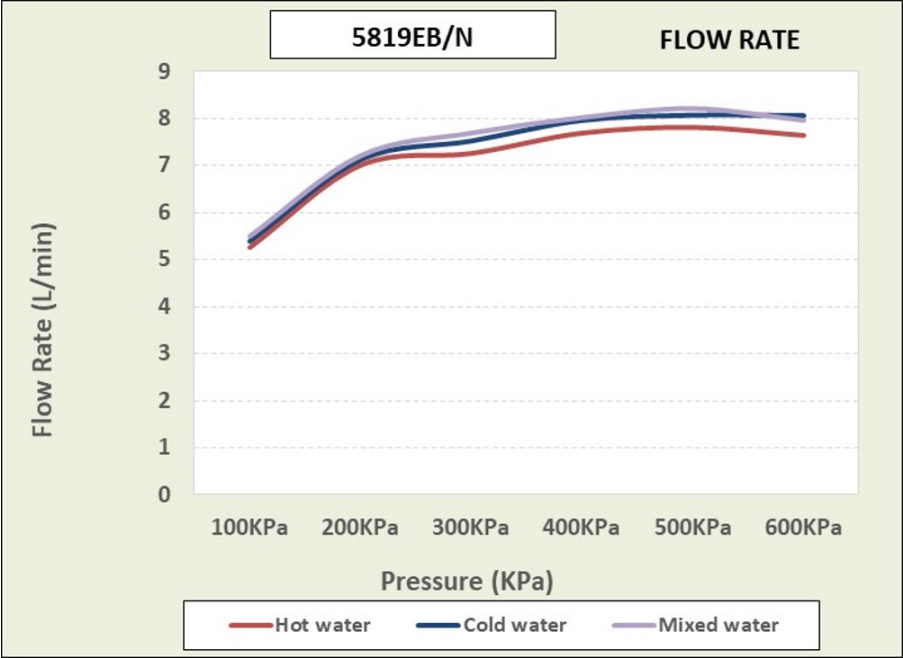

MOT



Cobra TeamAssist



Cobra FeatherTouch



DZR Brass



10 Year Warranty



2 years on coating