

Cobra Seine Matte Black Diverter Mixer Concealed



Range: Seine Matte Black

Description: Seine single lever concealed diverter mixer. Trim set & underwall body included. Underwall body manufactured with dezincification resistant (DZR) brass. Matt black items are coated using an electrophoresis coating process resulting in a thickness of between 20 - 25µm. 15mm female connection ends. 2 year warranty on black coating. Jaswic Approved Care & Maintenance - Ensure your product does not come into contact with any lubricants during installation. Chrome plated, matte black and any colour finishes should be wiped with warm soapy water and a soft cloth or sponge. Rinse, then dry and buff with a dry soft cloth. Under no circumstances must any detergents containing hydrochloric acids or abrasives including cream cleansers be used. Do not use abrasive cleaning materials such as scourers. Should your product have an aerator at the water outlet, it should be checked and cleaned regularly.

Product Code: 5811EB/N

ERP Code: FBSCW2BO-5EP01

Barcode: 6002194052326

Product Features: Cobra FeatherTouch, Cobra TeamAssist, 10 Year Warranty, DZR Brass, New Seine Ebony, 2 years on coating, New Seine Colours

Dimensions: (l) 210mm x (w) 160mm x (h) 80mm

Package Weight: 1.42

CAD3D: [Download](#)

Product Images

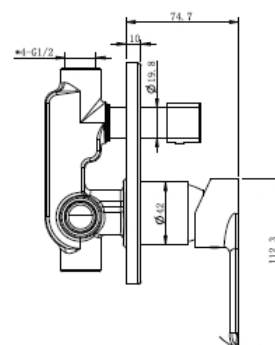
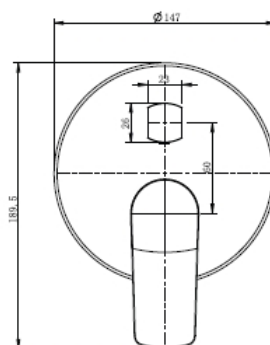

MOT



Cobra TeamAssist



Cobra FeatherTouch



DZR Brass



10 Year Warranty



2 years on coating