

Cobra Carina Sink Mixer

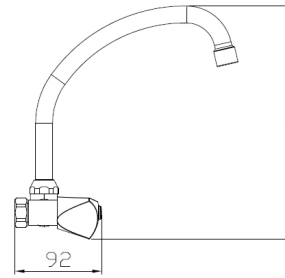

Range:	Carina
Description:	Carina wall-type sink mixer, with aerated swivel outlet, chrome. Includes: 1/2 BSP male inlets, and concealed connections. Care & Maintenance - Ensure your product does not come into contact with any lubricants during installation. Chrome plated, matte black and any colour finishes should be wiped with warm soapy water and a soft cloth or sponge. Rinse, then dry and buff with a dry soft cloth. Under no circumstances must any detergents containing hydrochloric acids or abrasives including cream cleansers be used. Do not use abrasive cleaning materials such as scourers. Should your product have an aerator at the water outlet, it should be checked and cleaned regularly.
Product Code:	266/041/10CA/N
ERP Code:	FSK2W2CA-0GT01
Barcode:	6002194052524
Product Features:	Cobra PureShine, Cobra TeamAssist, Cobra Genuine, Cobra EasySwitch, DZR Brass, 20 Year Warranty
Dimensions:	(l) 305mm x (w) 135mm x (h) 90mm
Package Weight:	1.13

Product Images

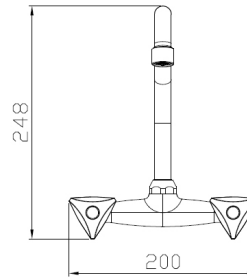

MOT



20 Year Warranty



Cobra Genuine



Cobra TeamAssist



Cobra PureShine



Cobra EasySwitch



DZR Brass