

Cobra Cobra Check Valve Swing 40



Range: Cobra

Description: Swing type. For use in ascending pipe runs. Hydraulic pressure 2000kPa (non-shock) max and steam pressure 880kPa @ 175degC max. 1 1/2BSP female iron connection ends.

Product Code: 1022-40/N

ERP Code: FCHESW40-7FT01

Barcode: 6002194033271

Product Features: Cobra TeamAssist, DZR Brass, 2 Year Warranty

Dimensions: (l) 130mm x (w) 120mm x (h) 90mm

Package Weight: 0.92

Product Images

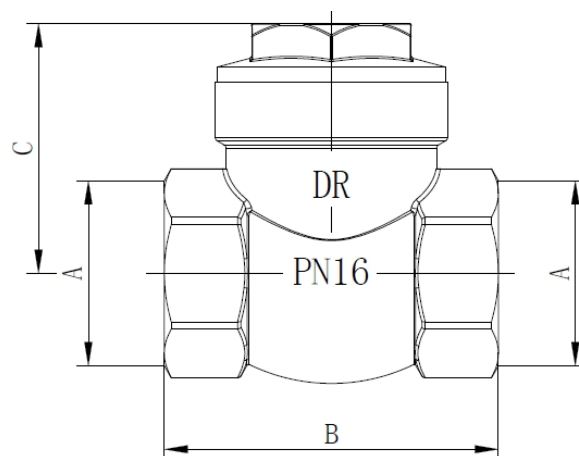

product-code	ERP code	A	B	C
1022-15/N	FCHESW15-7FT01	1/2	47	34
1022-20/N	FCHESW20-7FT01	3/4	57	39.5
1022-25/N	FCHESW25-7FT01	1	61	43
1022-32/N	FCHESW32-7FT01	1 1/4	70	48.5
1022-40/N	FCHESW40-7FT01	1 1/2	81.5	56.5
1022-50/N	FCHESW50-7FT01	2	93	63.5

MOT



Cobra TeamAssist



2 Year Warranty



DZR Brass