

Cobra 1002 25mm

**Range:** 1002

**Description:** Full-way light duty gate valve, cast brass. Includes: female to female connection ends, non-rising spindle and guided wedge, BSP parallel female threads and tested to 2400kPa. Non-DZR brass.

**Product Code:** 1002/125-25

**ERP Code:** FGV10225-7FT0140

**Barcode:** 6002194027423

**Product Features:** Cobra TeamAssist, Cobra Genuine, 2 Year Warranty

**Dimensions:** (l) 130mm x (w) 80mm x (h) 70mm

**Package Weight:** 0.48



Product Images

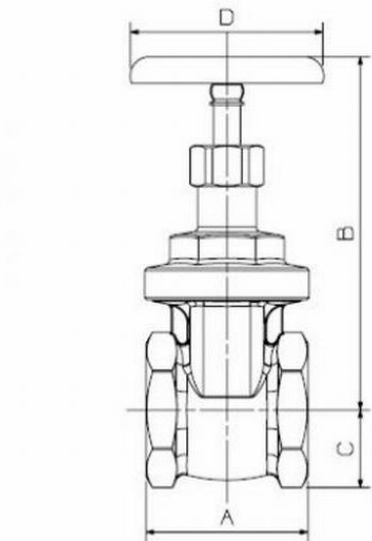

PRODUCT CODE	NOMINAL SIZE	SIZE	A	B	C	D	MASS
50102C-15-00-C	15mm	1/2"	41	73	14	52	211g
50102C-20-00-C	20mm	3/4"	46	84	17.5	58	307.8g
50102C-25-00-C	25mm	1"	51	91	21.5	58	445g
50102C-32-00-C	32mm	1 1/4"	58	107	26.5	70	690g
50102C-40-00-C	40mm	1 1/2"	58	116	30.25	78	855g
50102C-50-00-C	50mm	2"	70	140	37.5	78	1595g
50102C-65-00-C	65mm	2 1/2"	83	177	46.5	110	2500g
50102C-80-00-C	80mm	3"	90	194.5	53.75	130	3500g
50102C-10000-C	100mm	4"	101	247	69.25	175	5600g

Flow Chart

Flow Chart:

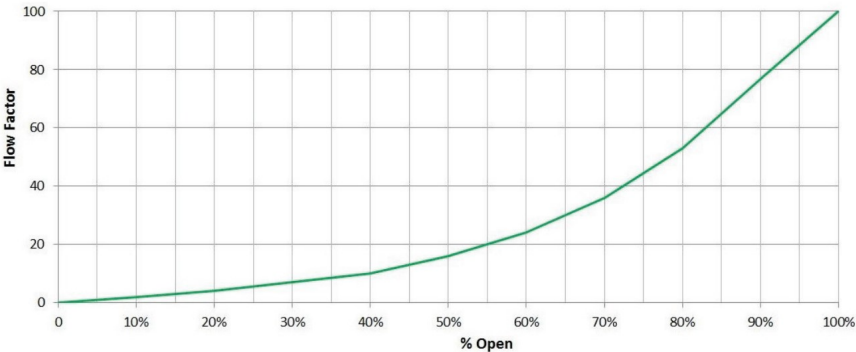

MOT



Cobra TeamAssist



Cobra Genuine



2 Year Warranty