



VAAL DIGITAL CATALOGUE



PART OF **LIXIL**



ABOUT US

Vaal Sanitaryware has been a go-to brand among homeowners and contractors for decades and has been in the ceramic sanitaryware business since 1946. Since then, the brand has evolved thanks to its commitment to improvement through quality, human-centred design, reliability and affordability.

Known for its timeless quality, durability, comfort and aesthetic appeal, Vaal is the brand of choice for the most discerning consumers.

Vaal's range of basins and toilets extends beyond domestic use and includes a range of project-specific items.



PRODUCT CARE & MAINTENANCE

Basins

Clean the basin with soap and water, as and when required. Should stubborn dirt prevail, a slightly abrasive cleaning material such as "Handy Andy" may be used.

Toilets

Clean the ceramic pan with soap and water, as and when required. Should stubborn dirt prevail, a slightly abrasive cleaning material such as "Handy Andy" may be used. The same applies to a polypropylene or thermoset toilet seat. Should a wooden toilet seat be used, a damp cloth must be used to clean the seat. No abrasive material must ever be used. The inside of the cistern should be kept free of dirt, as it could hamper the performance of the flush valve and the inlet valve. Should either of these valves malfunction, ensure that any dirt has been removed from all of the seals.

Maintenance

The frequency and extent of maintenance required for this product varies according to prevailing site and operational conditions. No regular maintenance is required and spare parts are available for key components.

LIXIL Africa Service call centre contact: 0861 21 21 21
LIXIL Africa Service E-Mail: service.lixil@lixil.com
Vaal website: vaal.lixil.co.za



GLOSSARY + GUIDELINE TABLE

HOW TO READ THIS PRODUCT CATALOGUE

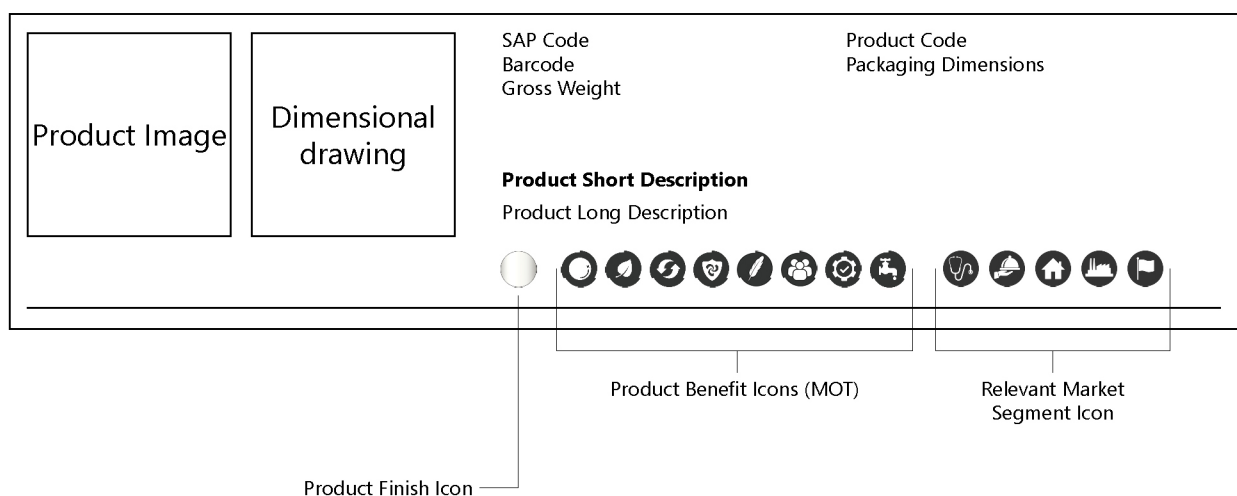

PRODUCT WARRANTY 01

LIXIL Africa warrants that their products will be clear of material and manufacturing defects. Appraisal of the above will be done against ruling manufacturing specifications and standards at the date of manufacture. Defective product will be repaired or exchanged at LIXIL Africa's sole discretion. LIXIL Africa shall not be liable for indirect or consequential loss or damage.

THE WARRANTY WILL BE VOIDED UNDER THE FOLLOWING CONDITIONS:

- Products used with water pH falling outside of the guidelines set by the Department of Water Affairs and Forestry or similar body
- Products not installed by a registered or accredited installer
- Products fitted with unbalanced water pressure
- Products fitted without an inline strainer
- Products used with or included in installations where water temperatures are outside of the temperature range stipulated for that product, or as laid down in the Standards for water supply and drainage (SANS 10252 & 10254) or an equivalent international standard
- Products not installed according to LIXIL Africa's or its suppliers' installation instructions or according to valid Water Regulations and general good plumbing practice
- Products which have failed as a result of dirt or debris in pipe-work which has not been flushed prior to the use of terminal fittings
- Where a defect is attributable to the incorrect use or incorrect handling of the product
- Where routine maintenance has been neglected
- If spare parts other than the original spare parts are used during repairs or maintenance of the product;
- If damage was caused by transport by a third-party transporter
- If products are used or intended for display purposes
- If consumables (e.g. filters, filter cartridges, aerators or batteries) or material subject to wear and tear (such as seals or hoses) are affected
- If product damage is as a result of chemicals and cleaning agents, lime-scale build-up, aggressive environmental influences, or disruptions resulting in damage which are caused by freezing or lime-scale build-up
- If the defect is caused by specific environmental circumstances (e.g. excess or negative pressure in the line, excess voltage or under voltage on the line)
- If the defect is attributable to willful or negligent damage to the product by the user or a third party
- Any product installed in such a manner that it is not accessible to do maintenance will not be covered under our warranty

PRODUCT WARRANTY 02

LIXIL Africa reserves the right to review any specific case in order to assess the validity of this warranty. LIXIL Africa may charge a discretionary service fee as may be reasonably determined by itself from time to time, when called out to inspect products which are not LIXIL Africa products or where there is an illegitimate claim.

THE WARRANTY IS VALID FOR:

ACRYLICS

Baths	10 Years
Shower Trays	10 Years

CERAMICS

Basins	10 Years
Sinks	10 Years
Urinals	10 Years
Bidets	10 Years
Toilets	10 Years
Toilet Seats	6 Months

SHOWERS (excluding Zambezi)

Shower Heads	5 Years
Handshowers	5 Years
Shower Rails	5 Years
Wall Outlets	5 Years
Shower Arms	5 Years
Shower Accessories	5 Years
Trigger Sprays	5 Years

ACCESSORIES

Bathroom Accessories	5 Years
Kitchen Accessories	5 Years
Bath spouts	20 Years

TAPS AND MIXERS

Single Levers, including G-23975003 Grohe Hybrid	20 Years
Single Lever Economy (Zambezi, Nile, Amazon and Seine ranges)	10 Years
Medical	20 Years
Public	2 Years
Rough Brass	20 Years
Screw Down	20 Years
Thermostatic	20 Years
Multi Way Diverter	20 Years
Electronic	2 Years
Colour finish excluding chrome	2 Years

SINKS

Sinks Stainless Steel	25 Years
-----------------------	----------

PRODUCT WARRANTY 03

THE WARRANTY IS VALID FOR:

CONCEALED CISTERNS

Grohe cistern	10 Years
Grohe actuator plates	5 Years
Cobra cistern	5 Years
Cobra actuator plates (with PVD coating and white)	3 Years
Cobra actuator plates (all other coating)	2 Years

SPARES

Ceramic disc cartridges excluding cartridges used in the economy single lever mixer ranges	15 Years
Ceramic disc cartridges used in the economy single lever mixer ranges (Zambezi, Nile, Amazon and Seine ranges)	2 Years
Cartridges used in Demand and Metering Taps	2 Years

PLUMBING FITTINGS

MLP pipe system, (must be used with Cobra compression fittings and Cobra-Safe inserts or warranty shall be void)	10 Years
Crimp MLP pipe system (must be used with Cobra crimp fittings or warranty shall be void)	10 Years
Compression fittings excluding rings and capnuts	20 Years

Flush Valves	2 Years
--------------	---------

Geyser Valves	2 Years
---------------	---------

ISOLATING VALVES

Angle Valves	2 Years
Ball Valves	2 Years
Check Valves	2 Years
Float Valves	2 Years
Gate Valves	2 Years
Strainers	2 Years

Electronic Range components and valves	2 Years
--	---------

Wastes	20 Years
--------	----------

PRODUCT WARRANTY 04

THE WARRANTY IS VALID FOR:

APEX ITEM NUMBERS

AP-20/25	1 Year
APT-15	1 Year
BB-40 and BB-50	1 Year
FLT-150B	1 Year
PB-20 and PB-25	1 Year
RA-20	1 Year
RES-32, RES-40 and RES-50	1 Year
RESDL-32, RESDL-40 and RESDL-50	1 Year
VSBALL	1 Year
220P-15, 220P-20 and 220P-25	1 Year
BB-32	1 Year
XF25/20	1 Year
XS25/20	1 Year
LSEV-400;22CXC	5 Years
LSEV-600;22CXC	5 Years
TP-600;M and TP-400M	5 Years
GEYSERP-400 and GEYSERP-600	5 Years

Note: Cartridge warranties are void should the cartridge be damaged in a situation where there is no inline strainer/filter.

MISCELLANEOUS:

This warranty shall apply in the above-mentioned scope and subject to the above-mentioned prerequisites. Proof of purchase will be required.

This LIXIL Africa warranty is carried by LIXIL Africa. Please contact our Service Department on +27 (0) 861 21 21 21 for warranty enquiries or further warranty information.

Table of Content

Vaal Basins

<u>Counter Top Basins</u>	<u>10</u>
<u>Semi-Recessed Basins</u>	<u>13</u>
<u>Underslung Basins</u>	<u>15</u>
<u>Drop-in Basins</u>	<u>17</u>
<u>Wall-Hung</u>	<u>19</u>

Vaal Sinks

<u>Butler</u>	<u>20</u>
<u>Laboratory</u>	<u>22</u>

Vaal Toilets

<u>Wall Hung Pans</u>	<u>23</u>
<u>Back-to-wall Pans</u>	<u>26</u>
<u>Close Couple Suites</u>	<u>28</u>
<u>Squat Pans</u>	<u>30</u>



COUNTER TOP BASINS

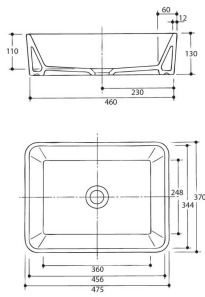

[CALBAJNN-2CO0400](#)

10.4

(l) 490mm x (w) 390mm x (h) 160mm

Vaal Alto Art Basin Counter Top 475X370

475x370mm rectangular counter top basin with no provision for tapholes or integrated overflow

Range: [Alto Art](#)

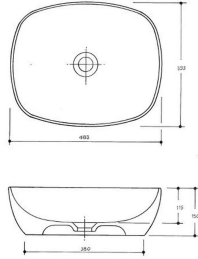

[CSY390NN-2CO0401](#)

9.6

(l) 490mm x (w) 410mm x (h) 160mm

Vaal HR Symmetry Basin Counter Top 483X393

483x393mm rectangular counter top basin with no provision for tapholes or integrated overflow

Range: [HR Symmetry](#)

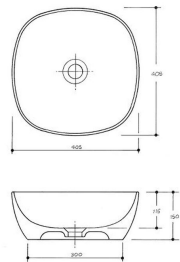

[CSY400NN-2CO0401](#)

9.6

(l) 430mm x (w) 440mm x (h) 170mm

Vaal HR Symmetry Basin Counter Top 405X405

405x405 counter top basin with no provision for tapholes or integrated overflow

Range: [HR Symmetry](#)

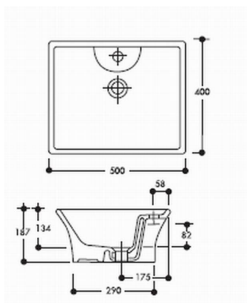

[COLBAA41-2CO0400](#)

15.28

(l) 520mm x (w) 450mm x (h) 240mm

Vaal Oriele Basin Counter Top 500X400

500x400mm rectangular counter top basin with 1 taphole and integrated overflow

Range: [Oriele](#)

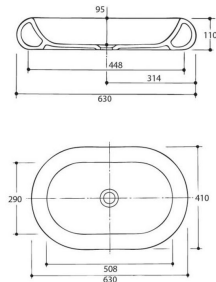

[CPERBABA-2CO0413](#)

12.16

(l) 650mm x (w) 460mm x (h) 140mm

Vaal Perla Basin Counter Top 630X410

630x410mm oval counter top basin with no provision for tapholes or integrated overflow

Range: [Perla](#)

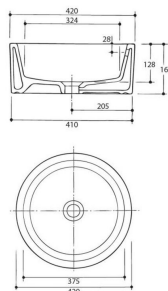

[CSABAJN1-2CO0400](#)

11.16

(l) 430mm x (w) 430mm x (h) 200mm

Vaal Savannah Basin Counter Top 420X420

420x420mm round counter top basin with integrated overflow. No provision for tapholes

Range: [Savannah](#)



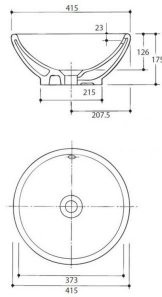

[CSVBAJN1-2CO0400](#)

8.3

(l) 440mm x (w) 440mm x (h) 210mm

Vaal Savoy Design Basin Counter Top 415X415

415x415mm round counter top basin with integrated overflow. No provision for tapholes

Range: [Savoy Design](#)

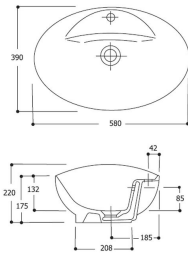

[CSFBAA41-2CO0400](#)

10.22

(l) 600mm x (w) 410mm x (h) 240mm

Vaal Swift Basin Counter Top 580X390

580x390mm oval counter top basin with 1 taphole and integrated overflow

Range: [Swift](#)

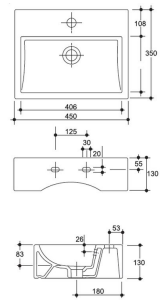

[CWEBIJ41-2CO0400](#)

11.3

(l) 480mm x (w) 390mm x (h) 170mm

Vaal Weaver Basin Midi Counter Top/Wall Hung 450X350

450x350mm rectangular counter top or wall hung basin with 1 taphole and integrated overflow

Range: [Weaver](#)

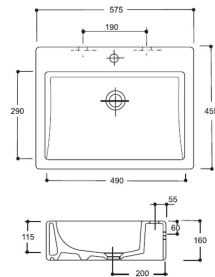

[CWEB1TBA-2CO0401](#)

19.1

(l) 600mm x (w) 490mm x (h) 190mm

Vaal Weaver Basin Counter Top/Wall Hung 575X455

575x455mm rectangular counter top or wall hung basin with 1 taphole and integrated overflow

Range: [Weaver](#)

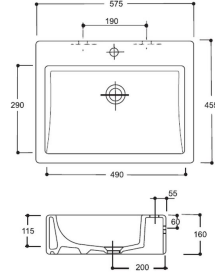

[CWEBXJN1-2CO0400](#)

18.9

(l) 600mm x (w) 490mm x (h) 200mm

Vaal Weaver Basin Counter Top/Wall Hung 575X455

575x455mm rectangular counter top or wall hung basin with integrated overflow. No provision for tapholes

Range: [Weaver](#)

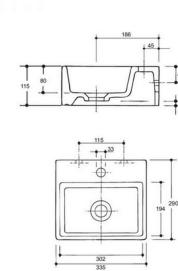

[CWEBMJ41-2CO0400](#)

6.5

(l) 360mm x (w) 310mm x (h) 140mm

Vaal Weaver Basin Mini Counter Top/Wall Hung 335X290

335x290mm rectangular counter top or wall hung basin with 1 taphole. No integrated overflow

Range: [Weaver](#)





SEMI-RECESSED BASINS

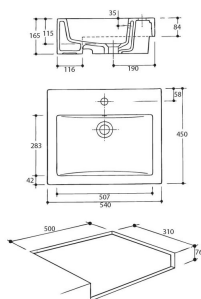

[CAZ54J41-2CO0417](#)

15.36

(l) 570mm x (w) 470mm x (h) 200mm

Vaal Azalea Basin Semi Recessed 540X450

Vitreous china 540x450x165mm semi-recessed basin with one taphole and integrated overflow.

Range: [Azalea](#)





UNDERSLUNG BASINS

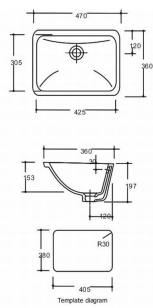

[CCRBAJN1-2CO0423](#)

8.3

(l) 480mm x (w) 370mm x (h) 220mm

Vaal Cardinal Basin Underslung 470X360

Vitreous china 470x360mm rectangular underslung basin, with integrated overflow. No provision for tapholes.

Range: [Cardinal](#)

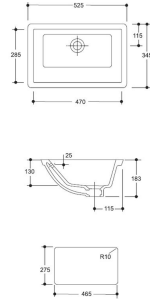

[CQLBAJNN-2CO0423](#)

8.1

(l) 550mm x (w) 370mm x (h) 210mm

Vaal Quail Basin Underslung 528X345X186

Quail rectangular underslung vanity basin, with integrated overflow. The basin has an unglazed contact surface area and is designed for fixing under vanity slab or in a bathroom cabinet using four hanger brackets (code 8125ZO). 528x345X186

Range: [Quail](#)

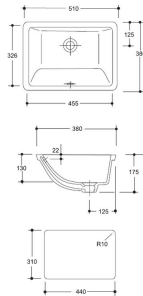

[CSNBAJNN-2CO0423](#)

8.8

(l) 540mm x (w) 410mm x (h) 220mm

Vaal Snipe Basin Underslung 510X380

Snipe rectangular underslung vanity basin, with integrated overflow. The basin has an unglazed contact surface area and is designed for fixing under vanity slab or in a bathroom cabinet using three or four hanger brackets (code 8125ZO). 510x380

Range: [Snipe](#)





DROP-IN BASINS

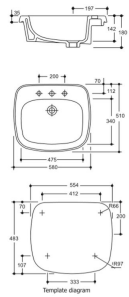

[CCOBAJBA-2CO0404](#)

13.22

(l) 620mm x (w) 570mm x (h) 250mm

Vaal Concorde Basin Drop In

Vaal Concorde basin drop in 580x510 white.

Range: [Concorde](#)

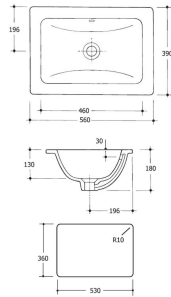

[CCODIB63-2CO0402](#)

9.16

(l) 590mm x (w) 420mm x (h) 200mm

Vaal Concorde Basin Drop In 560X390

560x390mm rectangular drop in basin with integrated overflow. No provision for tapholes

Range: [Concorde](#)

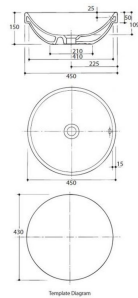

[CJABAJN1-2CO0400](#)

10.02

(l) 470mm x (w) 470mm x (h) 190mm

Vaal Jade Art Basin Drop In 450X450

450x450mm round basin with integrated overflow. No provision for tapholes

Range: [Jade Art](#)

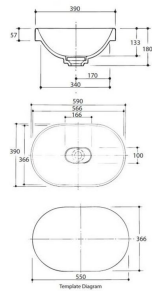

[CZIBAJNN-2CO0400](#)

9.6

(l) 610mm x (w) 410mm x (h) 210mm

Vaal Zircon Art Basin Drop In 590X390

590x390mm oval drop in basin with no provision for tapholes or integrated overflow

Range: [Zircon Art](#)





WALL HUNG TOILET PANS

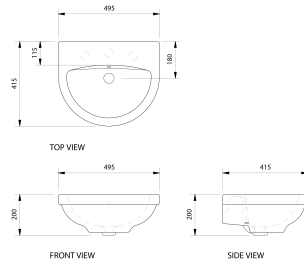

[1046390200](#)

12.34

(l) 415mm x (w) 495mm x (h) 200mm

Vaal Daisy Wall Hung Basin

Vaal Daisy Round wall hung basin. Dimensions: 415mm long, 495mm wide, 200mm high. 3 X pre-punched tap holes. With overflow. Compatible with all Grohe/Cobra Original screw down taps and single lever mixers. 10 Year LIXIL Africa warranty. Access to Cobra TeamAssist technical team.

Range: [Daisy](#)

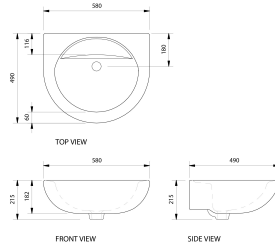

THIS DRAWING IS TO SCALE 1:10 ON A4

[1057760200](#)

16.1

(l) 490mm x (w) 580mm x (h) 215mm

Vaal Sola Wall Hung Basin

Semi-rectangular medical basin with 3 punched tapholes, no overflow or chain stay hole. Dimensions : 490LX575WX210H. Compatible with Lixil medical taps: 510-21/HP, 515/055-21/HP, 507/HP, G-32793000 . 10 Year Lixil Africa warranty. Access to Cobra TeamAssist technical team

Range: [Sola](#)

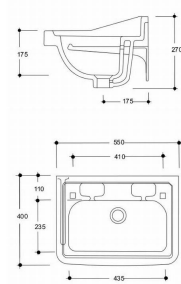

[CSPBAJ53-2CO0413](#)

14.66

(l) 570mm x (w) 450mm x (h) 290mm

Vaal Springbok Basin Wall Hung 550X400

Springbok basin 2th white boxed. Two brackets required per installation. 550x400

Range: [Springbok](#)



VAAL BUTLER

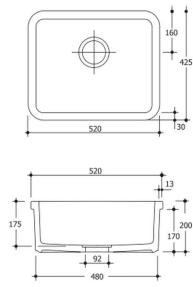

[CJBBAJN1-2CO0400](#)

17.4

(l) 540mm x (w) 450mm x (h) 230mm

Vaal James Sink Butler

Vitreous china 520x425x200mm rectangular butler sink without overflow, with centre back waste outlet. Excluding Waste

Range: [James](#)





Vaal
SANITARYWARE

SINKS

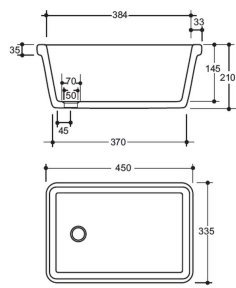

[CLA43J43-2CO0344](#)

11.6

(l) 470mm x (w) 360mm x (h) 240mm

Vaal Sink Laboratory

Vaal Sanitaryware vitreous china 450x335x210mm rectangular laboratory sink without overflow and a centre end waste outlet.

Range: [Vaal](#)



Image not found or type unknown



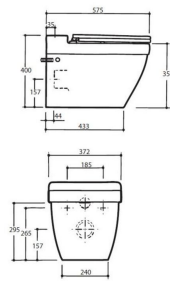

[CEVPA0NN-2CO0377](#)

35.3

(l) 600mm x (w) 410mm x (h) 470mm

Vaal Energy Toilet Pan Wall Hung

Vitreous china outlet back inlet closed rim wall-hung toilet, with quality thermoset soft-close seat.

Range: [Energy](#)

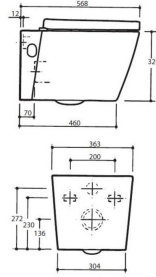

[CENPAFWH-2CO0377](#)

31.4

(l) 590mm x (w) 450mm x (h) 440mm

Vaal Entice Toilet Pan Wall Hung

Vitreous china 90 deg outlet back inlet rimless wall-hung toilet pan, with quality thermoset soft-close seat."

Range: [Entice](#)

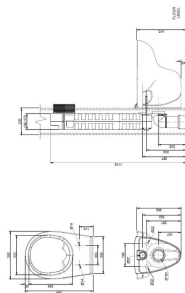

[CORBCCNN-2CO0413](#)

15.4

(l) 570mm x (w) 370mm x (h) 400mm

Vaal Orchid Toilet Pan Wall Hung

Back inlet closed rim pan. Compatible with concealed cistern, duct cistern or concealed flush valve. Designed to flush effectively on 6/3L

Range: [Orchid](#)

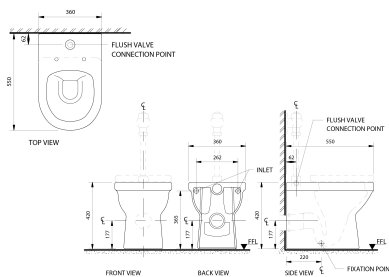

[1046380200](#)

45.24

(l) 550mm x (w) 360mm x (h) 420mm

Vaal Parktown Floor Mount Pan

Vaal Parktown top-entry floor-mounted pan. Excludes seat. Suitable for commercial use. Compatible with the following Cobra exposed flush valves: FJ2-000/N, FJ2-001/N, FJ2-210/N, FM1-000/N, FM1-210/N, FM1-214/N, FM2-210/N & FM2-214/N. Dimensions: 550mm long, 360mm wide, 420mm high. 10 Year LIXIL Africa warranty. Access to Cobra TeamAssist technical team.

Range: [Parktown](#)

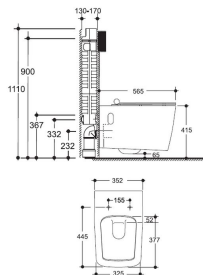

[CREFWHNN-2CO0377](#)

35.16

(l) 590mm x (w) 430mm x (h) 420mm

Vaal Refine Toilet Pan Wall Hung

Back inlet closed rim pan and thermoset soft close seat. Compatible with concealed cistern, duct cistern or concealed flush valve. Designed to flush effectively on 6/3L

Range: [Refine](#)



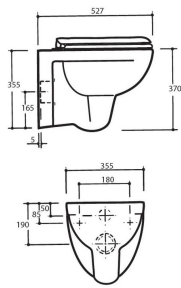

[CURB50WH-2CO0377](#)

23.4

(l) 550mm x (w) 430mm x (h) 420mm

Vaal Urban Toilet Pan Wall Hung

Back inlet rimless pan with thermoset soft close seat. Compatible with concealed cistern, duct cistern or concealed flush valve. Designed to flush effectively on 6/3L

Range: [Urban](#)

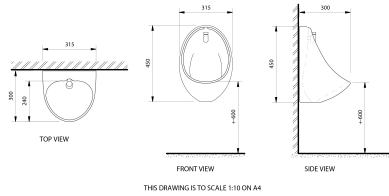

[1046400200](#)

10.94

(l) 300mm x (w) 315mm x (h) 450mm

Vaal Urinal

Vaal Flatback top-entry urinal. Spreader & fittings included. Suitable for commercial use. Compatible with the following Cobra exposed urinal flush valves: FJ6-000/N & FJ6-001/N. Dimensions: 300mm long, 315mm wide, 450mm high. 10 Year LIXIL Africa warranty. Access to Cobra TeamAssist technical team.

Range: [Vaal](#)



BACK-TO-WALL TOILET PANS

[CENTWHPA-2CO0372](#)

33.7

(l) 610mm x (w) 450mm x (h) 460mm

Vaal Entice Toilet Pan Back to Wall

Vitreous china 90 degree outlet back inlet rimless back to wall toilet pan, with quality thermoset soft close seat and floor brackets.

Range: [Entice](#)

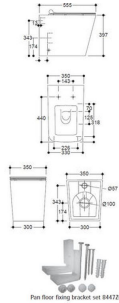
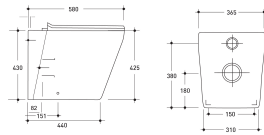

[CREBTWNN-2CO0372](#)

36.06

(l) 610mm x (w) 440mm x (h) 440mm

Vaal Refine Toilet Pan Back to Wall

Vitreous china 9 deg outlet back inlet closed rim back-to-wall toilet pan, with quality thermoset soft-close seat and floor brackets.

Range: [Refine](#)





CLOSE COUPLED SUITES

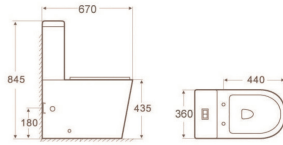

[CENT21SU-2CO0374](#)

54.85

(l) 750mm x (w) 450mm x (h) 640mm

Vaal Entice Toilet Close Couple Suite

Entice rimless cc suite, close coupled 90deg outlet rimless wash down pan and matching 6 litre top dual flush cistern, including soft close seat, 670x360mm white.

Range: [Entice](#)

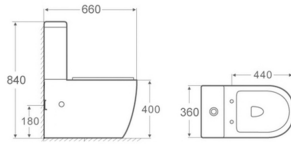

[CINPAFSU-2CO0374](#)

50.55

(l) 730mm x (w) 470mm x (h) 640mm

Vaal Ingenue Toilet Close Couple Suite

Ingenue rimless cc suite.

Range: [Ingenue](#)



[CREFWHSU-2CO](#)

56.05

(l) 730mm x (w) 450mm x (h) 610mm

Vaal Refine Toilet Close Couple Suite

Closed rim close coupled suite with 6/3L dual flush bottom inlet cistern and soft close thermoset double flap seat and floor mounting brackets

Range: [Refine](#)





SQUAT PANS

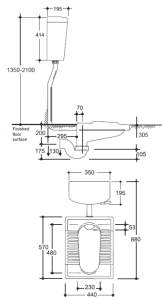

[COLSQ0NN-2CO0413](#)

15.2

(l) 620mm x (w) 480mm x (h) 320mm

Vaal Oriental Squat Pan

Oriental closed rim squat pan, with floor plate and integrated raised foot tread.

Range: [Oriental](#)



ONLINE PLATFORMS

Visit our website and find an
office/dealer/distributor closest to you

CONTACT

sales.africa@lixil.com
0861 21 21 21

WEBSITE:

vaal.lixil.co.za

SOCIAL MEDIA:



@VaalSanitaryware

LIXIL AFRICA (Pty) Ltd,
Suite 8 and 9, Block F, Saint Andrews Office Park,
OB Meadowbrook Lane, Epsom Downs Bryanston,
Sandton, South Africa 2152

PART OF **LIXIL**